

USER MANUAL



Q32E4U MONITOR

AOC.COM

©2025 AOC. All rights reserved

Version: A00

AOC

| | |
|--|----|
| Safety..... | 1 |
| National Conventions | 1 |
| Power..... | 2 |
| Installation | 3 |
| Cleaning..... | 4 |
| Other..... | 5 |
| Setup | 6 |
| Contents in Box..... | 6 |
| Set-up Stand & Base | 7 |
| Adjusting Viewing Angle | 8 |
| Connecting the Monitor | 9 |
| Wall Mounting | 10 |
| Adaptive-Sync function..... | 11 |
| Adjusting | 12 |
| Hotkeys..... | 12 |
| OSD Setting..... | 13 |
| Game Setting | 14 |
| Preset Mode..... | 15 |
| Picture..... | 16 |
| Input..... | 18 |
| Settings..... | 19 |
| Audio..... | 20 |
| OSD Setup | 21 |
| Information..... | 22 |
| LED Indicator | 23 |
| Troubleshoot | 24 |
| Specification | 25 |
| General Specification..... | 25 |
| AOC Monitors Panel Pixel Defect Policy..... | 26 |
| Preset Display Modes | 28 |
| Recommendations to prevent Computer Vision Syndrome (CVS)..... | 29 |
| Pin Assignments | 30 |
| Plug and Play | 31 |

Safety

National Conventions

The following subsections describe national conventions used in this document.

Notes, Cautions, and Warnings

Throughout this guide, blocks of text may be accompanied by an icon and printed in bold type or in italic type. These blocks are notes, cautions, and warnings, and they are used as follows:



NOTE: A NOTE indicates important information that helps you make better use of your computer system.



CAUTION: A CAUTION indicates either potential damage to hardware or loss of data and tells you how to avoid the problem.



WARNING: A WARNING indicates the potential for bodily harm and tells you how to avoid the problem. Some warnings may appear in alternate formats and may be unaccompanied by an icon. In such cases, the specific presentation of the warning is mandated by regulatory authority.

Power



The monitor should be operated only from the type of power source indicated on the label. If you are not sure of the type of power supplied to your home, consult your dealer or local power company.



The monitor is equipped with a three-pronged grounded plug, a plug with a third (grounding) pin. This plug will fit only into a grounded power outlet as a safety feature. If your outlet does not accommodate the three-wire plug, have an electrician install the correct outlet, or use an adapter to ground the appliance safely. Do not defeat the safety purpose of the grounded plug.



Unplug the unit during a lightning storm or when it will not be used for long periods of time. This will protect the monitor from damage due to power surges.



Do not overload power strips and extension cords. Overloading can result in fire or electric shock.



To ensure satisfactory operation, use the monitor only with UL listed computers which have appropriate configured receptacles marked between 100-240V AC, Min. 5A.



The wall socket shall be installed near the equipment and shall be easily accessible.

Installation



Do not place the monitor on an unstable cart, stand, tripod, bracket, or table. If the monitor falls, it can injure a person and cause serious damage to this product. Use only a cart, stand, tripod, bracket, or table recommended by the manufacturer or sold with this product. Follow the manufacturer's instructions when installing the product and use mounting accessories recommended by the manufacturer. A product and cart combination should be moved with care.



Never push any object into the slot on the monitor cabinet. It could damage circuit parts causing a fire or electric shock. Never spill liquids on the monitor.



Do not place the front of the product on the floor.



If you mount the monitor on a wall or shelf, use a mounting kit approved by the manufacturer and follow the kit instructions.



Leave some space around the monitor as shown below. Otherwise, air-circulation may be inadequate hence overheating may cause a fire or damage to the monitor.



To avoid potential damage, for example the panel peeling from the bezel, ensure that the monitor does not tilt downward by more than -5 degrees. If the -5 degree downward tilt angle maximum is exceeded, the monitor damage will not be covered under warranty.

See below the recommended ventilation areas around the monitor when the monitor is installed on the wall or on the stand:

Installed with stand

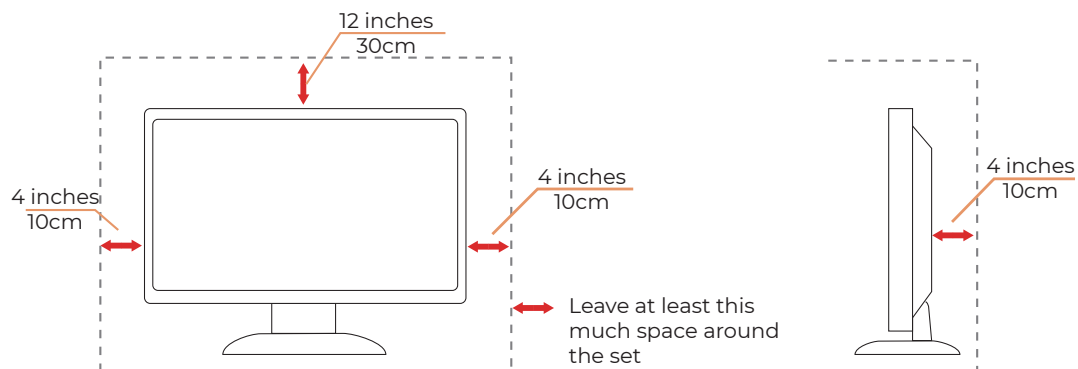

Cleaning

 Clean the cabinet regularly with a water-dampened, soft cloth.

 When cleaning use a soft cotton or microfiber cloth. The cloth should be damp and almost dry, do not allow liquid into the case.



 Please disconnect the power cord before cleaning the product.

Other



If the product is emitting a strange smell, sound or smoke, disconnect the power plug IMMEDIATELY and contact a Service Center.



Make sure that the ventilating openings are not blocked by a table or curtain.



Do not engage the LCD monitor in severe vibration or high impact conditions during operation.



Do not knock or drop the monitor during operation or transportation.



The power cords shall be safety approved. For Germany, it shall be H03VV-F, 3G, 0.75 mm², or better. For other countries, the suitable types shall be used accordingly.



Excessive sound pressure from earphones and headphones can cause hearing loss. Adjustment of the equalizer to maximum increases the earphones and headphones output voltage and therefore the sound pressure level.



Low Blue Light: The display uses the low blue light panel. It complies with TÜV Rheinland Low Blue Light Hardware Solution certification under factory reset/default setting.

Health:

- The monitor should be 50 ~ 70 cm (20 ~ 28 inches) away from your eyes.
- Looking at the screen for an extended period of time causes eye fatigue and may deteriorate your eyesight. Rest your eyes for 5 ~ 10 minutes for every 1 hour of product use.
- Reduce your eye strain by focusing on objects far way.
- Frequent blinking and eye exercise help keep your eyes from drying out.



Flicker-free technology maintains a stable backlight with a DC dimmer that eliminates the primary cause of monitor flicker, making it easier on the eyes.

Setup

Contents in Box

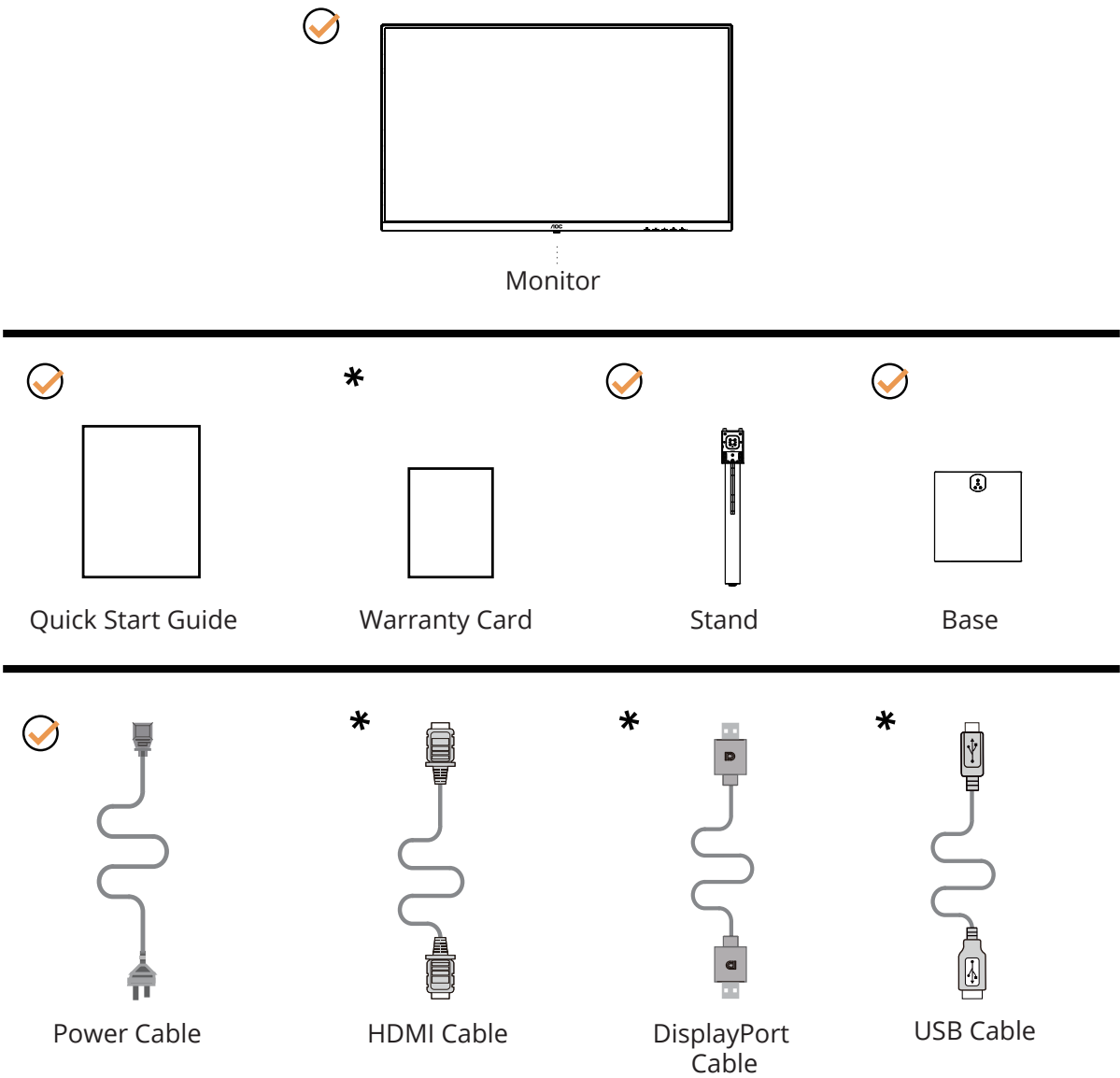

✦ Not all signal cables will be provided for all countries and regions. Please check with the local dealer or AOC branch office for confirmation.

Set-up Stand & Base

Please setup or remove the base following the steps as below.

Setup:

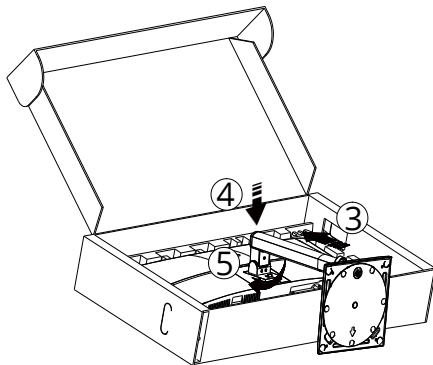
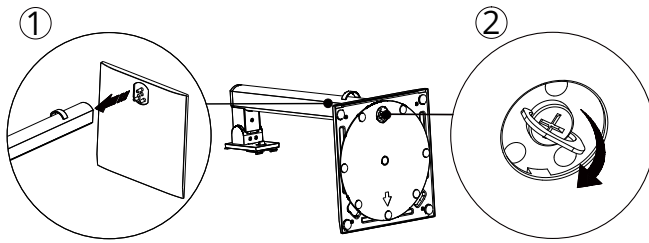

Remove:

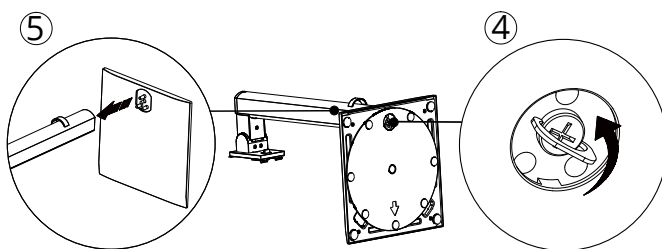
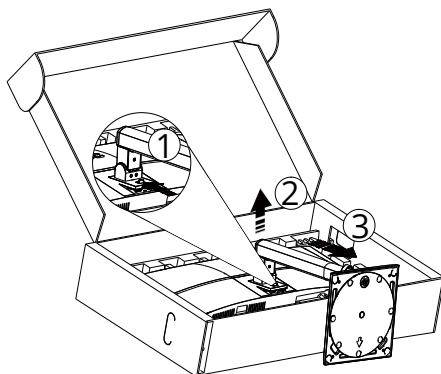

Specification for base screw: M6*13 mm (effective thread 5.5 mm)

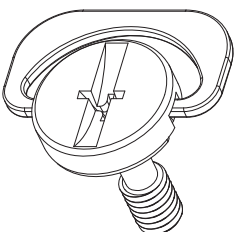

NOTE: Display design may differ from those illustrated.

Adjusting Viewing Angle

To achieve the best viewing experience, it is recommended that the user can make sure they are able to look at their whole face on the screen, then adjust the monitor's angle based on personal preference. Hold the stand so you will not topple the monitor when you change the monitor's angle. You are able to adjust the monitor as below:

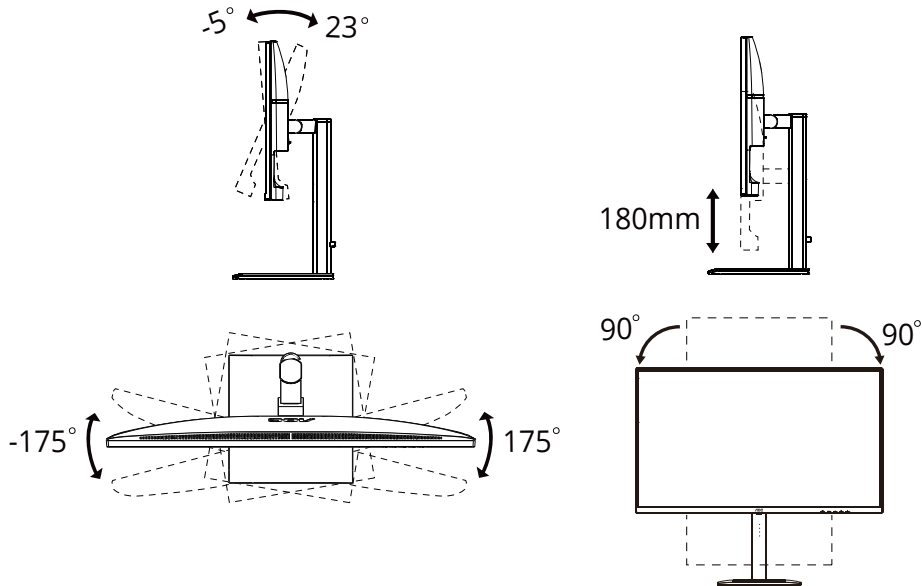

NOTE:

Do not touch the LCD screen when you change the angle. Touching the LCD screen may cause damage.

⚠ Warning

- To avoid potential screen damage, such as panel peeling, ensure that the monitor does not tilt downward by more than -5 degrees.
- Do not press the screen while adjusting the angle of the monitor. Grasp only the bezel.

Connecting the Monitor

Cable Connections In Back of Monitor and Computer:

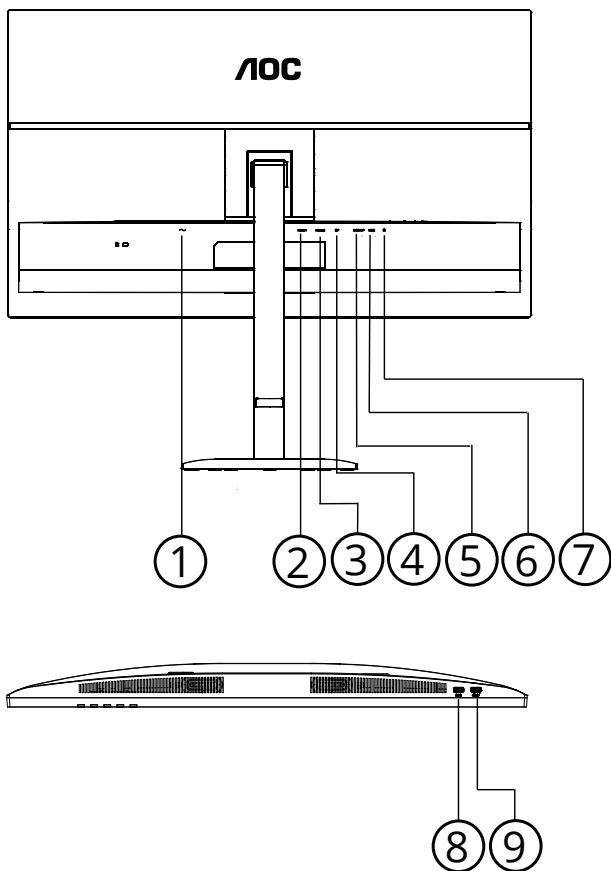

1. Power
2. HDMI1
3. HDMI2
4. DisplayPort
5. USB Upstream
6. USB3.2 Gen1 downstreamx2
7. Earphone
8. USB3.2 Gen1 downstream
9. USB3.2 Gen1 downstream+charging

Connect to PC

1. Connect the power cord to the back of the display firmly.
2. Turn off your computer and unplug its power cable.
3. Connect the display signal cable to the video connector on the back of your computer.
4. Plug the power cord of your computer and your display into a nearby outlet.
5. Turn on your computer and display.

If your monitor displays an image, installation is complete. If it does not display an image, please refer to Troubleshoot.

To protect equipment, always turn off the PC and LCD monitor before connecting.

Wall Mounting

Preparing to install an optional wall mounting arm.

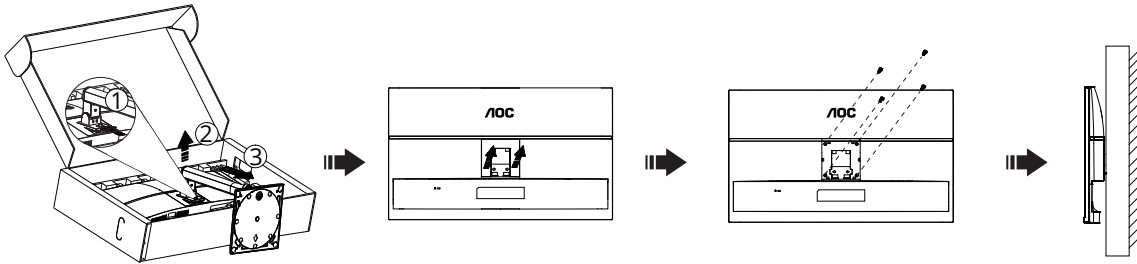

This monitor can be attached to a wall mounting arm you purchase separately. Disconnect power before this procedure. Follow these steps:

1. Remove the base.
2. Follow the manufacturer's instructions to assemble the wall mounting arm.
3. Place the wall mounting arm onto the back of the monitor. Line up the holes of the arm with the holes in the back of the monitor.
4. Insert the 4 screws into the holes and tighten.
5. Reconnect the cables. Refer to the user's manual that came with the optional wall mounting arm for instructions on attaching it to the wall.

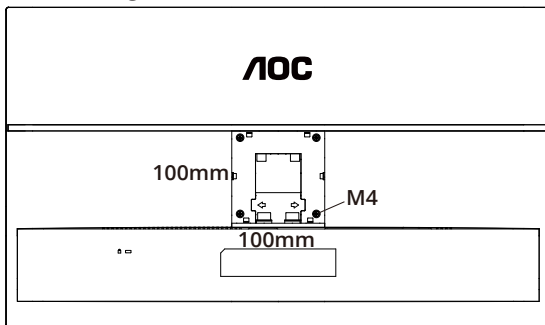

Specification of wall hanger screws: M4*(10+X)mm, (X=Thickness of Wall mount bracket)

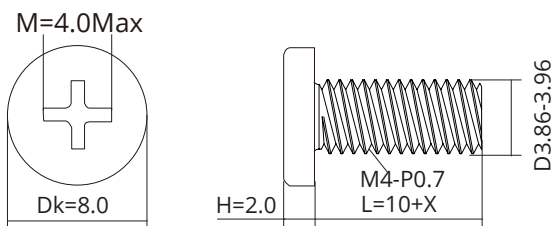

Noted: VESA mounting screw holes are not available for all models, please check with the dealer or official department of AOC. Always contact manufacturer for wall-mount installation.

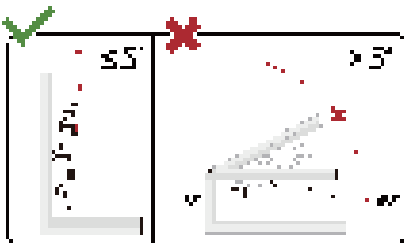

* Display design may differ from those illustrated.

⚠WARNING:

1. To avoid potential screen damage, such as panel peeling, ensure that the monitor does not tilt downward by more than -5 degrees.
2. Do not press the screen while adjusting the angle of the monitor. Grasp only the bezel.

Adaptive-Sync function

1. Adaptive-Sync function works with DisplayPort/HDMI
2. Compatible Graphics Card: Recommended list is as below, also could be checked by visiting www.AMD.com

Graphics Cards

- Radeon™ RX Vega series
- Radeon™ RX 500 series
- Radeon™ RX 400 series
- Radeon™ R9/R7 300 series (R9 370/X, R7 370/X, R7 265 except)
- Radeon™ Pro Duo (2016)
- Radeon™ R9 Nano series
- Radeon™ R9 Fury series
- Radeon™ R9/R7 200 series (R9 270/X, R9 280/X except)

Processors

- AMD Ryzen™ 7 2700U
- AMD Ryzen™ 5 2500U
- AMD Ryzen™ 5 2400G
- AMD Ryzen™ 3 2300U
- AMD Ryzen™ 3 2200G
- AMD PRO A12-9800
- AMD PRO A12-9800E
- AMD PRO A10-9700
- AMD PRO A10-9700E
- AMD PRO A8-9600
- AMD PRO A6-9500
- AMD PRO A6-9500E
- AMD PRO A12-8870
- AMD PRO A12-8870E
- AMD PRO A10-8770
- AMD PRO A10-8770E
- AMD PRO A10-8750B
- AMD PRO A8-8650B
- AMD PRO A6-8570
- AMD PRO A6-8570E
- AMD PRO A4-8350B
- AMD A10-7890K
- AMD A10-7870K
- AMD A10-7850K
- AMD A10-7800
- AMD A10-7700K
- AMD A8-7670K
- AMD A8-7650K
- AMD A8-7600
- AMD A6-7400K

Adjusting

Hotkeys

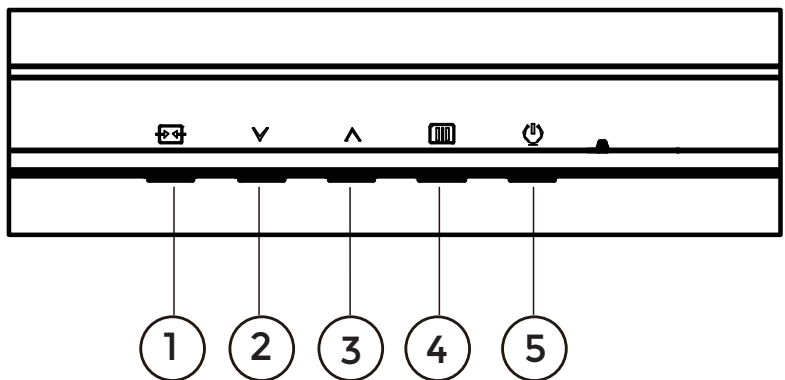

| | |
|---|---------------|
| 1 | Source/Exit |
| 2 | Preset Mode/▼ |
| 3 | Brightness/▲ |
| 4 | Menu/Enter |
| 5 | Power |

Menu/Enter

Press to display the OSD or confirm the selection.

Power

Press the Power button to turn on the monitor.

Preset Mode/▼

When there is no OSD, press “▼” key to open Preset Mode function, then press “▼” or “▲” key to select Preset Mode.

Brightness/▲

When there is no OSD, press “▲” key to open Brightness function, then press “▼” or “▲” key to adjust the brightness.

Source/Exit















When the OSD is closed, press Source/Exit button will be Source hot key function.

When the OSD menu is active, this button acts as an exit key (to exit the OSD menu).

OSD Setting

Basic and simple instruction on the control keys.

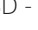

- 1). Press the  **MENU-button** to activate the OSD window.
- 2). Press  or  to navigate through the functions. Once the desired function is highlighted, press the  **MENU-button / OK** to activate it, press  or  to navigate through the sub-menu functions. Once the desired sub-menu function is highlighted, press  **MENU-button / OK** to activate it.
- 3). Press  or  to change the settings of the selected function. Press  /  to exit. If you want to adjust any other function, repeat steps 2-3.
- 4). OSD Lock Function: To lock the OSD, press and hold the  MENU-button while the monitor is off and then press  power button to turn the monitor on. To unlock the OSD - press and hold the  MENU-button while the monitor is off and then press  power button to turn the monitor on.

Notes:

- 1). If the product has only one signal input, the item of "Input Select" is unable to be adjusted.
- 2). If the input signal resolution is the native resolution or Adaptive-Sync, then the item "Image Ratio" is invalid.

Game Setting



| | | |
|----------------|------------------------------|--|
| Shadow Control | 0 ~ 20 | Shadow Control Default is 0, then end-user can adjust from 0 to 20 increase for a clearer picture. If picture is too dark to be saw the detail clearly, adjusting from 0 to 20 for a clear picture. |
| Game Color | 0 ~ 20 | Game Color will provide 0-20 level for adjusting saturation to get a better picture. |
| Adaptive-Sync | Off / On | Disable or Enable Adaptive-Sync. Adaptive-Sync Run Reminder: When the Adaptive-Sync feature is enabled, there may be flashing in some game environments. |
| Dial Point | Off / On / Dynamic | The "Dial Point" function places an aiming indicator in the center of screen for helping gamers to play First Person Shooter (FPS) games with accurate and precise aiming. |
| Overdrive | Off / Weak / Medium / Strong | Adjust the response time. Note: If the user adjusts OverDrive to "Strong" the displayed image may be blurred. Users can adjust the OverDrive level or turn it off according to their preferences. |

Note:

When the "Color Space" under "Picture" is set to "sRGB", the items "Shadow Control" and "Game Color" can not be adjusted.

Preset Mode

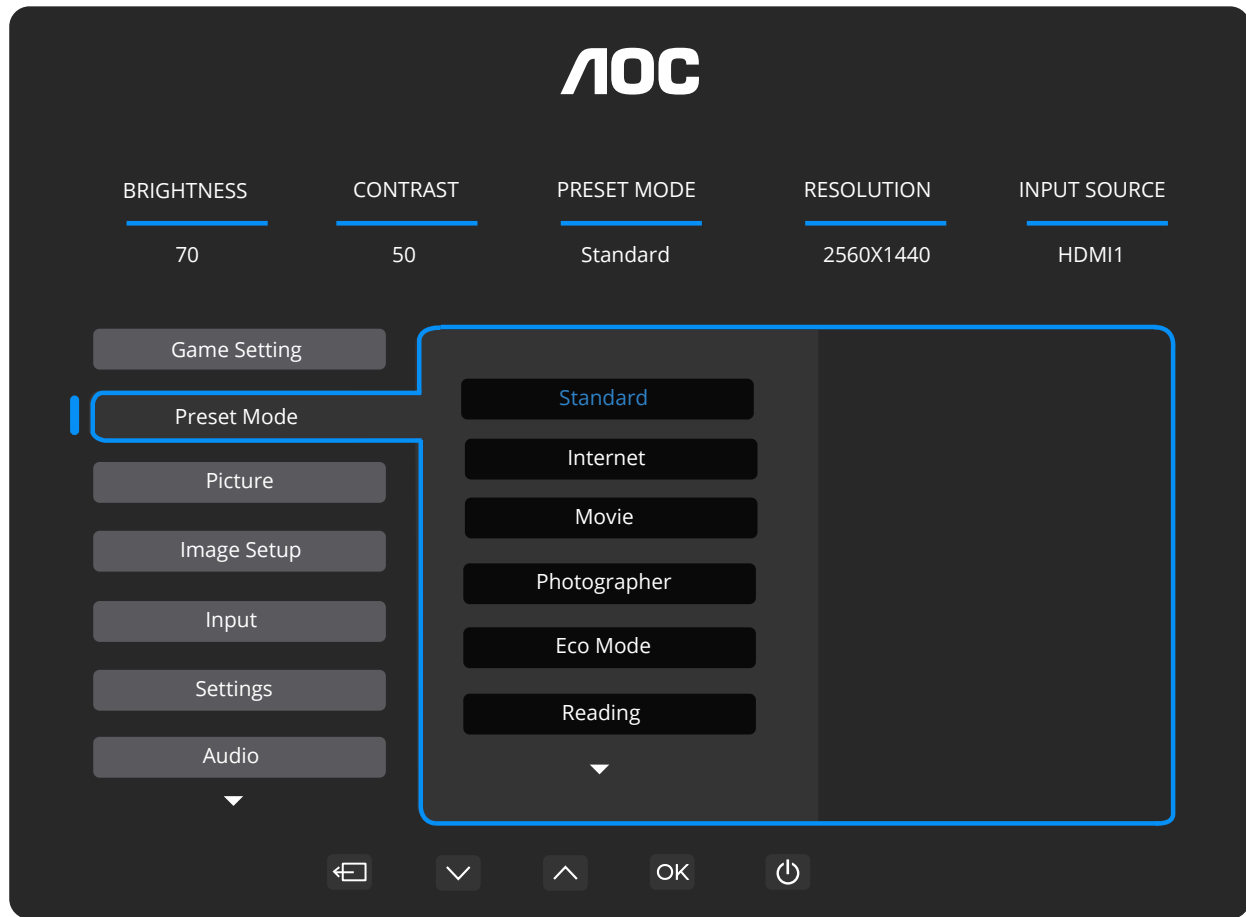

| | |
|----------------------|---|
| Standard | Enhance readability for suitable web and mobile games. |
| Internet | Internet Mode. |
| Movie | Movie Mode. |
| Photographer | Photographer Mode. |
| Eco Mode | Eco Mode |
| Reading | Reading Mode. |
| HDR Effect - Picture | Set the HDR Effect according to your usage requirements. |
| HDR Effect - Movie | |
| HDR Effect - Game | |
| Sports | Sports Mode. |
| D-Mode | D-Mode Mode. |
| FPS | For playing FPS (First Person Shooters) games. Improves black level in dark theme. |
| RTS | For playing RTS (Real Time Strategy) games. Improves the image quality. |
| Racing | For playing Racing games, Provides fastest response time and high color saturation. |
| Reset Color | Reset the Color to default. |

Picture

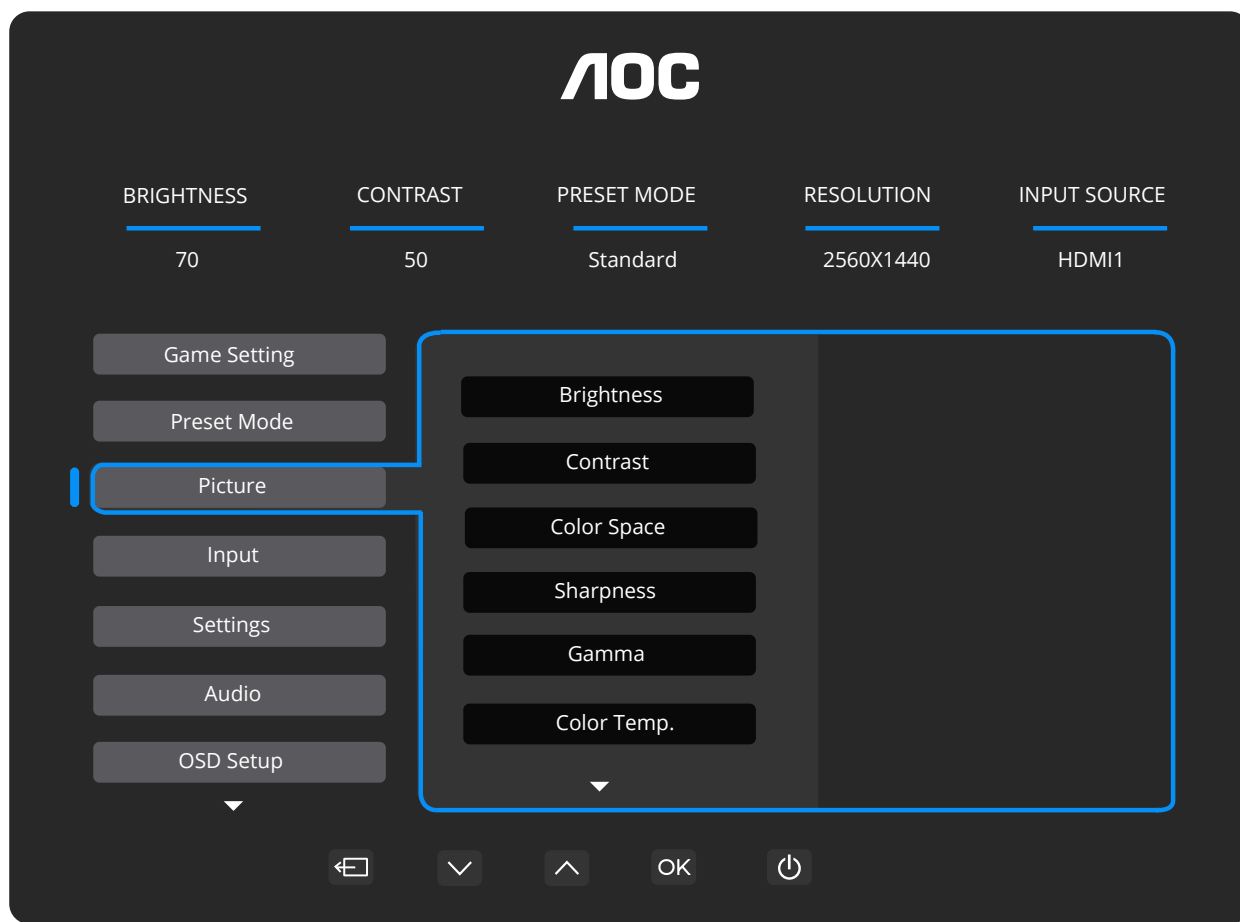

| | | |
|-------------|---------------------|--|
| Brightness | 0-100 | Backlight Adjustment. |
| Contrast | 0-100 | Contrast from Digital-register. |
| Color Space | Panel Native | Standard color space panel. |
| | sRGB | sRGB Color space. |
| Sharpness | 0-100 | Sharpness Adjustment. |
| Gamma | 1.8/2.0/2.2/2.4/2.6 | Adjust Gamma. |
| Color Temp. | Native | Recall Native Color Temperature from EEPROM. |
| | 5000K | Recall 5000K Color Temperature from EEPROM. |
| | 6500K | Recall 6500K Color Temperature from EEPROM. |
| | 7500K | Recall 7500K Color Temperature from EEPROM. |
| | 8200K | Recall 8200K Color Temperature from EEPROM. |
| | 9300K | Recall 9300K Color Temperature from EEPROM. |
| | 11500K | Recall 11500K Color Temperature from EEPROM. |
| | User Define | Restore Color Temperature from EEPROM. |
| Red | 0-100 | Red gain from Digital-register. |

| | | |
|--------------|----------------------------|--|
| Green | 0-100 | Green gain from Digital-register. |
| Blue | 0-100 | Blue gain from Digital-register. |
| DCR | Off | Disable dynamic contrast ratio. |
| | On | Enable dynamic contrast ratio. |
| Clear Vision | Off/Weak/Medium/ Strong | Full-screen apply sharpening function. |
| Image Ratio | Full/Aspect | Select image ratio for display. |

Note:

When the "Color Space" under "Picture" is set to "sRGB", the items "Contrast", "Gamma" and "Color Temp." cannot be adjusted.

Input



| | |
|-------------|---|
| Auto | Select input signal source Automatically. |
| HDMI1 | Select HDMI1 input signal source. |
| HDMI2 | Select HDMI2 input signal source. |
| DisplayPort | Select DisplayPort input signal source. |

Settings



| | | |
|-------------------|--------------|---|
| Language | | Select the OSD language. |
| Break Reminder | Off / On | Break reminder if the user continuously works for more than 1hrs. |
| Off Timer(hr) | 0-24 | Select DC off time. |
| DDC/CI | No / Yes | Turn On/Off DDC/CI Support. |
| Resolution Notice | Off / On | Optimal resolution prompt. |
| Reset | No / Yes | Reset the menu to default. |
| | ENERGY STAR® | ENERGY STAR® available for selective models. |

Audio



| | | |
|--------|----------|--------------------|
| Volume | 0-100 | Volume Adjustment. |
| Mute | Off / On | Mute the volume. |

OSD Setup

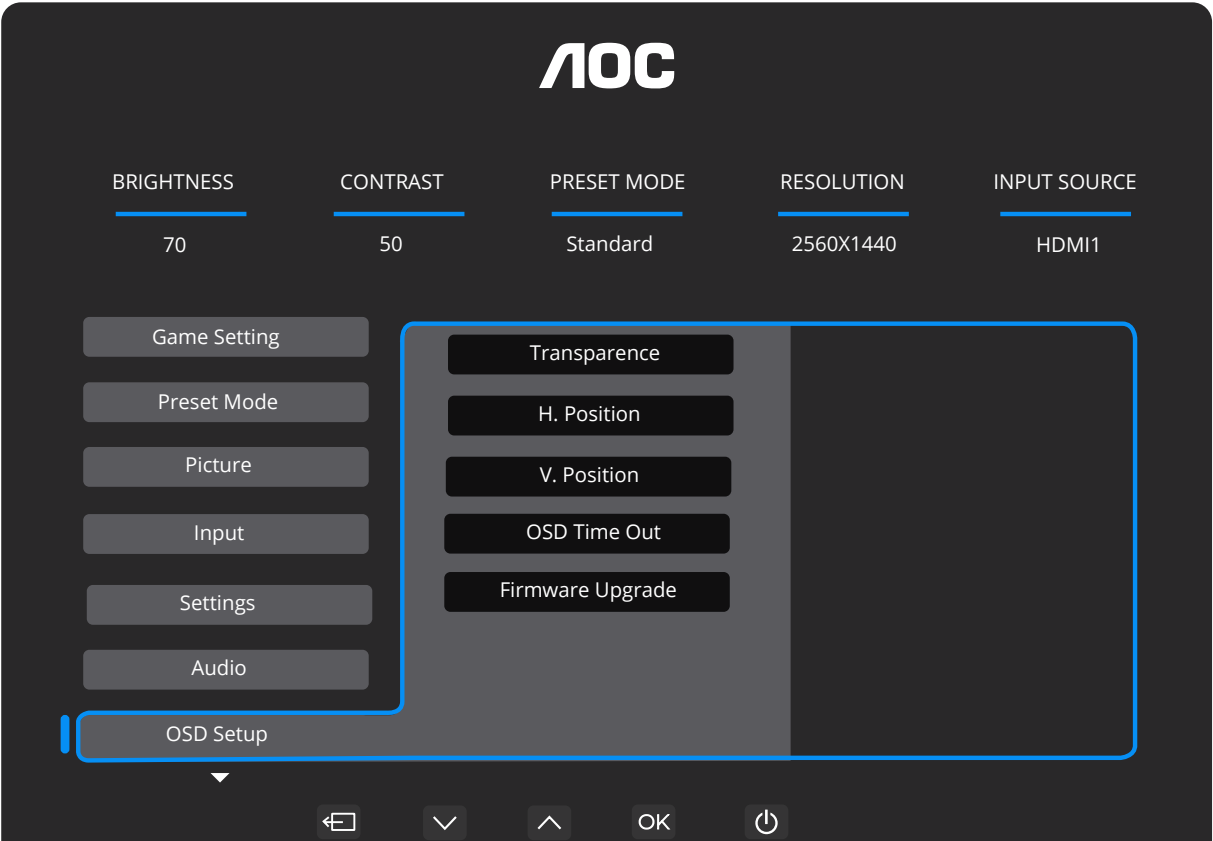

| | | |
|------------------|----------|--|
| Transparence | 0-100 | Adjust the transparence of OSD. |
| H. Position | 0-100 | Adjust the horizontal position of OSD. |
| V. Position | 0-100 | Adjust the vertical position of OSD. |
| OSD Time Out | 5-120 | Adjust the OSD Timeout. |
| Firmware Upgrade | No / Yes | Upgrade the FW via USB. |

Information



LED Indicator

| Status | LED Color |
|-----------------|-----------|
| Full Power Mode | White |
| Active-off Mode | Orange |

Troubleshoot

| Problem & Question | Possible Solutions |
|---|---|
| Power LED Is Not ON | Make sure the power button is ON and the Power Cord is properly connected to a grounded power outlet and to the monitor. |
| No image on the screen | <ul style="list-style-type: none"> ■ Is the power cord connected properly? Check the power cord connection and power supply. ■ Is the video cable connected correctly? (Connected using the HDMI cable) Check the HDMI cable connection. (Connected using the DisplayPort cable) Check the DisplayPort cable connection. * HDMI/DisplayPort input is not available on every model. ■ If the power is on, reboot the computer to see the initial screen (the login screen.) If the initial screen (the login screen) appears, boot the computer in the applicable mode (the safe mode for Windows 7/8/10) and then change the frequency of the video card. (Refer to the Setting the Optimal Resolution) If the initial screen (the login screen) does not appear, contact the Service Center or your dealer. ■ Can you see "Input Not Supported" on the screen? You can see this message when the signal from the video card exceeds the maximum resolution and frequency that the monitor can handle properly. Adjust the maximum resolution and frequency that the monitor can handle properly. ■ Make sure the AOC Monitor Drivers are installed. |
| Picture Is Fuzzy & Has Ghosting Shadowing Problem | Adjust the Contrast and Brightness Controls. Press hot-key (AUTO) to auto-adjust. Make sure you are not using an extension cable or switch box. We recommend plugging the monitor directly to the video card output connector on the back. |
| Picture Bounces, Flickers Or Wave Pattern Appears In The Picture | Move electrical devices that may cause electrical interference as far away from the monitor as possible. Use the maximum refresh rate your monitor is capable of at the resolution you are using. |
| Monitor Is Stuck In Active Off-Mode" | The Computer Power Switch should be in the ON position. The Computer Video Card should be snugly fitted in its slot. Make sure the monitor's video cable is properly connected to the computer. Inspect the monitor's video cable and make sure no pin is bent. Make sure your computer is operational by hitting the CAPS LOCK key on the keyboard while observing the CAPS LOCK LED. The LED should either turn ON or OFF after hitting the CAPS LOCK key. |
| Missing one of the primary colors (RED, GREEN, or BLUE) | Inspect the monitor's video cable and make sure that no pin is damaged. Make sure the monitor's video cable is properly connected to the computer. |
| Screen image is not centered or sized properly | Adjust H-Position and V-Position or press hot-key (AUTO). |
| Picture has color defects (white does not look white) | Adjust RGB color or select desired color temperature. |
| Horizontal or vertical disturbances on the screen | Use Windows 7/8/10/11 shut-down mode to adjust CLOCK and FOCUS. Press hot-key (AUTO) to auto-adjust. |
| Regulation & Service | Please refer to Regulation & Service Information at www.aoc.com (to find the model you purchase in your country and to find Regulation & Service Information in Support page.) |

Specification

General Specification

| | | | |
|--------------------------|-------------------------------|--|--------------------------|
| Panel | Model name | Q32E4U | |
| | Driving system | TFT Color LCD | |
| | Viewable Image Size | 80.1 cm diagonal | |
| | Pixel pitch | 0.2727mm(H) x 0.2727mm (V) | |
| | Display Color | 1.07B (8bits+FRC) ^[1] | |
| Others | Horizontal scan range | 30k~150kHz | |
| | Horizontal scan Size(Maximum) | 698.112mm | |
| | Vertical scan range | 48~100Hz | |
| | Vertical Scan Size(Maximum) | 392.688mm | |
| | Optimal preset resolution | 2560x1440@60Hz | |
| | Max resolution | 2560x1440@100Hz | |
| | Plug & Play | VESA DDC2B/CI | |
| | Power Source | 100-240V~ 50/60Hz 1.5A | |
| | Power Consumption | Typical(default brightness and contrast) | 26W |
| | | Max. (brightness = 100, contrast =100) | ≤82W |
| | | Standby Mode | ≤0.5W |
| | Heat Dissipation | Normal Operation | 88.74BTU/hr (typ.) |
| | | Sleep (Standby mode) | <1.71 BTU/hr |
| | | Off mode | <1.02 BTU/hr |
| Physical Characteristics | Connector Type | HDMI/DisplayPort/USB/Earphone out | |
| | Signal Cable Type | Detachable | |
| Environmental | Temperature | Operating | 0°C~40°C |
| | | Non-Operating | -25°C~55°C |
| | Humidity | Operating | 10%~85% (Non-Condensing) |
| | | Non-Operating | 5%~93% (Non-Condensing) |
| | Altitude | Operating | 0m~5000m (0ft~16404ft) |
| | | Non-Operating | 0m~12192m (0ft~40000ft) |



Note:

[1]The maximum number of display colors supported by this product is 1.07 billion, and the setting conditions are as follows (there may be differences due to the output limitation of some graphics cards)

("V":support, "\":nonsupport):

| Signal Version Color Format State Color Bit | HDMI2.0 | | DisplayPort1.4 | |
|--|----------------------|-----------------|----------------------|-----------------|
| | YCbCr420 YCbCr422 | YCbCr444 RGB | YCbCr420 YCbCr422 | YCbCr444 RGB |
| 2560x1440@100Hz 10bits | V | \ | V | V |
| 2560x1440@100Hz 8bits | V | V | V | V |
| Minimum: 1920x1080@60Hz, 10bit | V | V | V | V |

[2] :In order for the monitor to function properly, your PC's graphics card must support DisplayPort 1.2 or HDMI 2.0. The display resolution and refresh rate are also dependent on the computer's graphic card capability.

AOC Monitors Panel Pixel Defect Policy

AOC strives to deliver the highest quality products. We use some of the industry's most advanced manufacturing processes and practice stringent quality control. However, pixel or sub pixel defects on the Monitor panels used in the monitors are sometimes unavoidable.

No manufacturer can guarantee that all panels will be free from pixel defects, but AOC guarantees that any monitor with an unacceptable number of defects will be repaired or replaced under warranty. This notice explains the different types of pixel defects and defines acceptable defect levels for each type. In order to qualify for repair or replacement under warranty, the number of pixel defects on a Monitor panel must exceed these acceptable levels. For example, no more than 0.0004% of the sub pixels on a monitor may be defective.

Furthermore, AOC sets even higher quality standards for certain types or combinations of pixel defects that are more noticeable than others. This policy is valid worldwide.

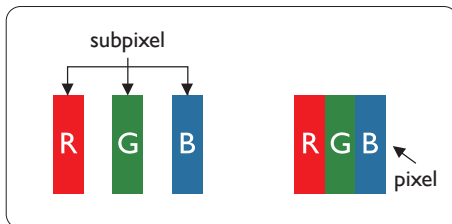

Pixels and Sub pixels

A pixel, or picture element, is composed of three sub pixels in the primary colors of red, green and blue. Many pixels together form an image. When all sub pixels of a pixel are lit, the three colored sub pixels together appear as a single white pixel. When all are dark, the three colored sub pixels together appear as a single black pixel. Other combinations of lit and dark sub pixels appear as single pixels of other colors.

Types of Pixel Defects

Pixel and sub pixel defects appear on the screen in different ways. There are two categories of pixel defects and several types of sub pixel defects within each category.

Bright Dot Defects

Bright dot defects appear as pixels or sub pixels that are always lit or 'on'. That is, a bright dot is a sub-pixel that stands out on the screen when the monitor displays a dark pattern. There are the types of bright dot defects.

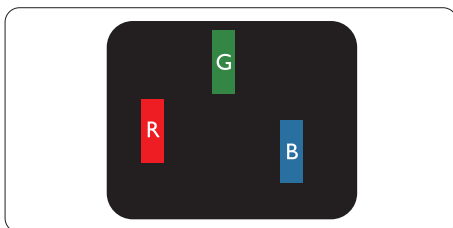

One lit red, green or blue sub pixel.

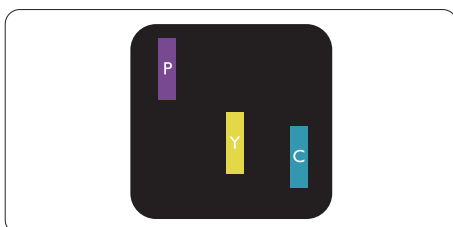

Two adjacent lit sub pixels:

- Red + Blue = Purple
- Red + Green = Yellow
- Green + Blue = Cyan (Light Blue)

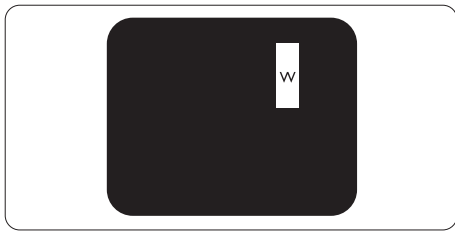

Three adjacent lit sub pixels (one white pixel).

Note

A red or blue bright dot must be more than 50 percent brighter than neighboring dots while a green bright dot is 30 percent brighter than neighboring dots.

Black Dot Defects

Black dot defects appear as pixels or sub pixels that are always dark or 'off'. That is, a dark dot is a sub-pixel that stands out on the screen when the monitor displays a light pattern. These are the types of black dot defects.

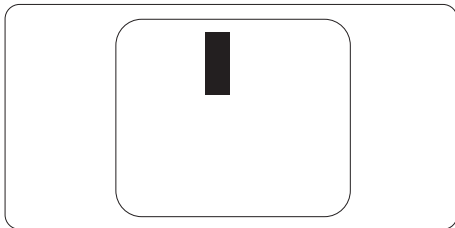

Proximity of Pixel Defects

Because pixel and sub pixels defects of the same type that are near to one another may be more noticeable, AOC also specifies tolerances for the proximity of pixel defects.

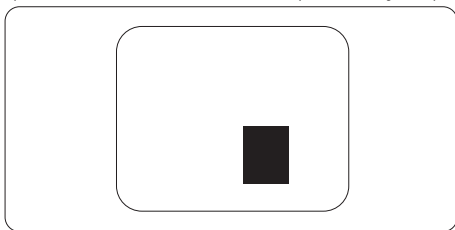

Pixel Defect Tolerances

In order to qualify for repair or replacement due to pixel defects during the warranty period, a Monitor panel in a AOC panel monitor must have pixel or sub pixel defects exceeding the tolerances listed in the web manual.

| BRIGHT DOT DEFECTS | ACCEPTABLE LEVEL |
|--|--------------------|
| 1 lit subpixel | 2 |
| 2 adjacent lit subpixels | 1 |
| 3 adjacent lit subpixels (one white pixel) | 0 |
| Distance between two bright dot defects* | $\geq 15\text{mm}$ |
| Total bright dot defects of all types | 2 |
| BLACK DOT DEFECTS | ACCEPTABLE LEVEL |
| 1 dark subpixel | 5 or fewer |
| 2 adjacent dark subpixels | 2 or fewer |
| 3 adjacent dark subpixels | ≤ 1 |
| Distance between two black dot defects* | $\geq 15\text{mm}$ |
| Total black dot defects of all types | 5 or fewer |
| TOTAL DOT DEFECTS | ACCEPTABLE LEVEL |
| Total bright or black dot defects of all types | 5 or fewer |

Note

*: 1 or 2 adjacent sub pixel defects = 1 dot defect.

Preset Display Modes

| STANDARD | RESOLUTION($\pm 1\text{Hz}$) | HORIZONTAL FREQUENCY(KHz) | VERTICAL FREQUENCY(Hz) |
|---------------|--------------------------------|---------------------------|------------------------|
| VGA | 640x480@60Hz | 31.47 | 59.94 |
| | 640x480@72Hz | 37.86 | 72.81 |
| | 640x480@75Hz | 37.50 | 75.00 |
| MAC MODES VGA | 640x480@67Hz | 35.00 | 66.67 |
| IBM MODE | 720x400@70Hz | 31.47 | 70.09 |
| SVGA | 800x600@56Hz | 35.16 | 56.25 |
| | 800x600@60Hz | 37.88 | 60.32 |
| | 800x600@72Hz | 48.08 | 72.19 |
| | 800x600@75Hz | 46.88 | 75.00 |
| MAC MIDE SVGA | 832x624@75Hz | 47.73 | 74.55 |
| XGA | 1024x768@60Hz | 48.36 | 60.00 |
| | 1024x768@70Hz | 56.48 | 70.07 |
| | 1024x768@75Hz | 60.02 | 75.03 |
| SXGA | 1280x1024@60Hz | 63.89 | 60.02 |
| | 1280x1024@75Hz | 79.98 | 75.03 |
| WSXG | 1280x720@60Hz | 44.77 | 59.86 |
| | 1280x960@60Hz | 60.00 | 60.00 |
| WXGA+ | 1440x900@60Hz | 55.94 | 59.89 |
| WSXGA+ | 1680x1050@60Hz | 65.29 | 59.95 |
| FHD | 1920x1080@60HZ | 67.50 | 60.00 |
| | 1920x1080@75HZ | 83.93 | 75.00 |
| QHD | 2560x1440@60Hz | 67.50 | 60.00 |
| | 2560x1440@75Hz | 111.08 | 75.00 |
| | 2560x1440@100Hz | 148.50 | 100.00 |

Note: According to the VESA standard, there may be a certain error ($\pm 1\text{Hz}$) when calculating the refresh rate (field frequency) of different operating systems and graphics cards. In order to improve compatibility, the nominal refresh rate of this product has been rounded off. Please refer to the actual product.

Recommendations to prevent Computer Vision Syndrome (CVS)

(Only applicable to the model of application)

AOC monitors are designed with TÜV Rheinland® EyeComfort 3.0 to prevent eyestrain caused by prolonged computer use. This advanced four-star rating standard ensures reduced visual fatigue through a combination of hardware and design features which are enabled by default on your monitor.

Easy-on-eyes features:

- **Anti-glare screen:** The matte anti-glare coating minimizes reflections from ambient lighting sources such as windows or overhead lamps, reducing visual distractions and improving screen clarity.
- **Flicker-free technology:** Utilizes direct current (DC) backlight control to maintain consistent brightness levels in order to eliminate screen flickering — a common source of eye fatigue.
- **LowBlue mode:** This monitor reduces harmful blue light exposure from less than 50 percent to under 35 percent, helping to protect your eyes without compromising color quality. The low blue light feature is set to be the default factory setting to comply with TÜV Rheinland's hardware low blue light certification.
- **Reading mode:** Reading mode provides a paper-like reading experience that is best suited for reviewing long documents, articles or eBooks. This allows a more natural and comfortable reading experience by adjusting the contrast, brightness and color temperature thereby reducing eye strain during extended reading sessions.

To reduce eye fatigue and enhance productivity, follow these best practices when setting up your workstation:

- **Optimize Ergonomics:** Position your desk and chair so that your feet rest flat on the floor, your eyes are approximately one arm's length from the screen, and your hands can rest comfortably on the keyboard and mouse. Your eye level should be five to seven cm (two to three inches) below the top edge of the monitor. If you wear bifocal or progressive lenses, adjust the monitor height to minimize head tilting.
- **Maintain Healthy Viewing Distance:** Keep a distance of **50 to 70 centimeters (20 to 28 inches)** between your eyes and the screen. Prolonged screen exposure can cause eye fatigue and may impact vision. To reduce strain, **rest your eyes for five to ten minutes** after every hour of screen use. Regularly shifting your focus to distant objects can also help relax your eye muscles.
- **Adjust Display Settings:** Choose the most suitable monitor mode for your tasks, or manually adjust the brightness and contrast to your comfort level.
- **Manage Lighting:** Ensure that your screen is free from glare or reflections caused by overhead lights or windows. Match the lighting behind the monitor to the screen's brightness, particularly when displaying light backgrounds. Avoid fluorescent lights and highly reflective surfaces.
- **Build Healthy Work Habits:** Blink often and maintain good eye care practices to help prevent dryness and discomfort. Frequent, shorter breaks are more effective than fewer, longer ones in maintaining visual comfort throughout the day.
- **Practice Eye and Neck Exercises:** Periodically focus on distant objects to reduce eye strain. Close your eyes and gently roll them in circles. To release tension, stretch your neck by slowly tilting your head forward, backward, and side to side.

Pin Assignments

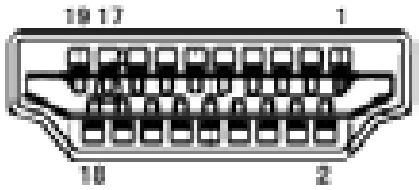

19-Pin Color Display Signal Cable

| Pin No. | Signal Name | Pin No. | Signal Name | Pin No. | Signal Name |
|---------|--------------------|---------|---------------------------|---------|-----------------|
| 1. | TMDS Data 2+ | 9. | TMDS Data 0- | 17. | DDC/CEC Ground |
| 2. | TMDS Data 2 Shield | 10. | TMDS Clock + | 18. | +5V Power |
| 3. | TMDS Data 2- | 11. | TMDS Clock Shield | 19. | Hot Plug Detect |
| 4. | TMDS Data 1+ | 12. | TMDS Clock- | | |
| 5. | TMDS Data 1Shield | 13. | CEC | | |
| 6. | TMDS Data 1- | 14. | Reserved (N.C. on device) | | |
| 7. | TMDS Data 0+ | 15. | SCL | | |
| 8. | TMDS Data 0 Shield | 16. | SDA | | |

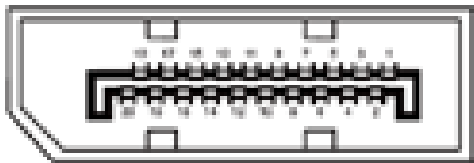

20-Pin Color Display Signal Cable

| Pin No. | Signal Name | Pin No. | Signal Name |
|---------|---------------|---------|-----------------|
| 1 | ML_Lane 3 (n) | 11 | GND |
| 2 | GND | 12 | ML_Lane 0 (p) |
| 3 | ML_Lane 3 (p) | 13 | CONFIG1 |
| 4 | ML_Lane 2 (n) | 14 | CONFIG2 |
| 5 | GND | 15 | AUX_CH(p) |
| 6 | ML_Lane 2 (p) | 16 | GND |
| 7 | ML_Lane 1 (n) | 17 | AUX_CH(n) |
| 8 | GND | 18 | Hot Plug Detect |
| 9 | ML_Lane 1 (p) | 19 | Return DP_PWR |
| 10 | ML_Lane 0 (n) | 20 | DP_PWR |

Plug and Play

Plug & Play DDC2B Feature

This monitor is equipped with VESA DDC2B capabilities according to the VESA DDC STANDARD. It allows the monitor to inform the host system of its identity and, depending on the level of DDC used, communicate additional information about its display capabilities.

The DDC2B is a bi-directional data channel based on the I2C protocol. The host can request EDID information over the DDC2B channel.

