

AGON

P R O



OLED Monitor

User Manual

AG276QKD2

As an OLED product, this display needs regular screen maintenance to reduce the risk of image retention (burn-in).

AOC

www.aoc.com

©2025 AOC. All Rights Reserved

HDMI®

HIGH-DEFINITION MULTIMEDIA INTERFACE

Safety	1
Notational Conventions	1
Power	2
Installation	3
Cleaning	4
Other	5
Setup	6
Contents in Box	6
Setup Stand & Base	7
Adjusting the monitor	9
Connecting the Monitor	10
Wall Mounting	11
Adaptive-Sync function	12
HDR	13
Adjusting	14
Hotkeys	14
OSD Key Guide (Menu)	15
OSD Setting	16
Game Setting	17
Luminance	19
OLED Care/Extra	21
Color Setup	23
Audio	25
Light FX	26
PIP Setting	27
OSD Setup	28
LED Indicator	29
Troubleshooting	30
Specification	31
General Specification	31
Preset Display Modes	33
Pin Assignments	34
Plug and Play	35

Safety

Notational Conventions

The following subsections describe notational conventions used in this document.

Notes, Cautions, and Warnings

Throughout this guide, blocks of text may be accompanied by an icon and printed in bold type or in italic type. These blocks are notes, cautions, and warnings, and they are used as follows:



NOTE: A NOTE indicates important information that helps you make better use of your computer system.



CAUTION: A CAUTION indicates either potential damage to hardware or loss of data and tells you how to avoid the problem.



WARNING: A WARNING indicates the potential for bodily harm and tells you how to avoid the problem. Some warnings may appear in alternate formats and may be unaccompanied by an icon. In such cases, the specific presentation of the warning is mandated by regulatory authority.

Power



The monitor should be operated only from the type of power source indicated on the label. If you are not sure of the type of power supplied to your home, consult your dealer or local power company.



The monitor is equipped with a three-pronged grounded plug, a plug with a third (grounding) pin. This plug will fit only into a grounded power outlet as a safety feature. If your outlet does not accommodate the three-wire plug, have an electrician install the correct outlet, or use an adapter to ground the appliance safely. Do not defeat the safety purpose of the grounded plug.



Unplug the unit during a lightning storm or when it will not be used for long periods of time. This will protect the monitor from damage due to power surges.



Do not overload power strips and extension cords. Overloading can result in fire or electric shock.



To ensure satisfactory operation, use the monitor only with UL listed computers which have appropriate configured receptacles marked between 100-240V AC, Min. 5A.



The wall socket shall be installed near the equipment and shall be easily accessible.





For use only with the attached power adapter

Manufacturers: TPV Electronics (Fujian) Co., Ltd..

Model: ADPC19135

Installation

 Do not place the monitor on an unstable cart, stand, tripod, bracket, or table. If the monitor falls, it can injure a person and cause serious damage to this product. Use only a cart, stand, tripod, bracket, or table recommended by the manufacturer or sold with this product. Follow the manufacturer's instructions when installing the product and use mounting accessories recommended by the manufacturer. A product and cart combination should be moved with care.

 Never push any object into the slot on the monitor cabinet. It could damage circuit parts causing a fire or electric shock. Never spill liquids on the monitor.

 Do not place the front of the product on the floor.

 If you mount the monitor on a wall or shelf, use a mounting kit approved by the manufacturer and follow the kit instructions.

 Leave some space around the monitor as shown below. Otherwise, air-circulation may be inadequate hence overheating may cause a fire or damage to the monitor.

 To avoid potential damage, for example the panel peeling from the bezel, ensure that the monitor does not tilt downward by more than -5 degrees. If the -5 degree downward tilt angle maximum is exceeded, the monitor damage will not be covered under warranty.

See below the recommended ventilation areas around the monitor when the monitor is installed -on the stand:

Installed with stand

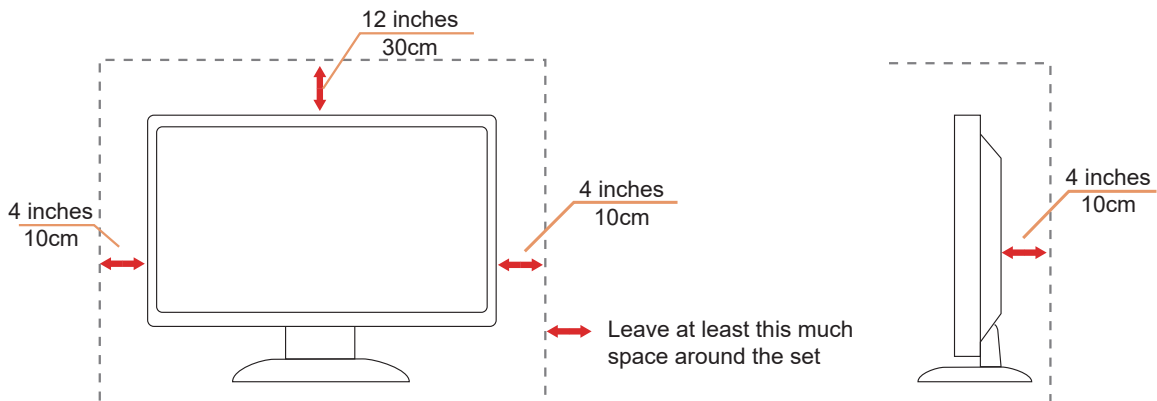

Cleaning

 Clean the cabinet regularly with a water-dampened, soft cloth.

 When cleaning use a soft cotton or microfiber cloth. The cloth should be damp and almost dry, do not allow liquid into the case.



 Please disconnect the power cord before cleaning the product.

Other



If the product is emitting a strange smell, sound or smoke, disconnect the power plug IMMEDIATELY and contact a Service Center.



Make sure that the ventilating openings are not blocked by a table or curtain.



Do not engage the OLED monitor in severe vibration or high impact conditions during operation.



Do not knock or drop the monitor during operation or transportation.



It is not recommended to use this OLED product for more than four continuous hours. Possible image retention (burn-in) may occur beyond this usage duration. To reduce the probability of image retention this product uses a number of technologies. A maintenance cycle takes about 10 minutes. For details, refer to the “Screen Maintenance” section.

Setup

Contents in Box

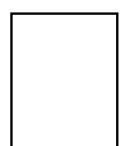
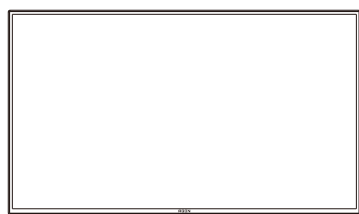

Quick Start

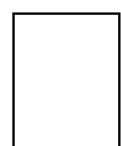

Warranty card



Stand

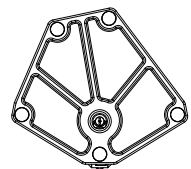

Base

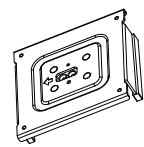

Wall Mount Bracket

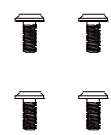

Stand Screws



Screwdriver



Power Cable



Adaptor



DisplayPort Cable



HDMI Cable



USB Cable

***** Not all signal cables will be provided for all countries and regions. Please check with the local dealer or AOC branch office for confirmation.

Setup Stand & Base

Please setup or remove the base following the steps as below.

Setup:

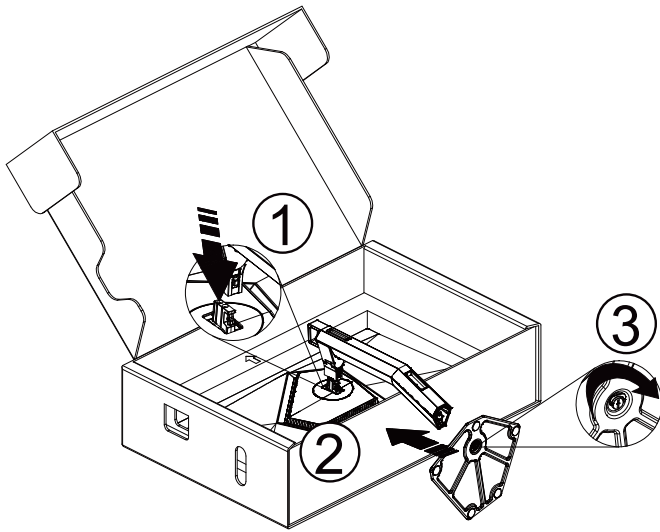

Remove:

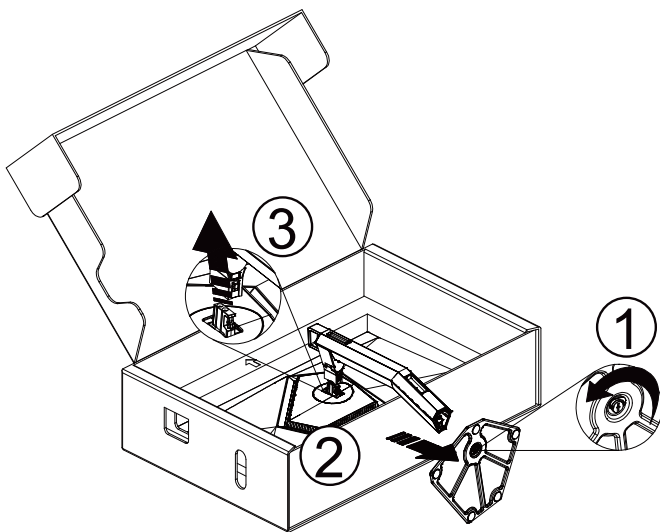

Wall hanger:

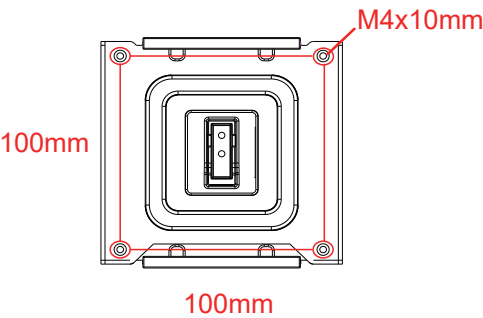

Specification of wall hanger screws: M4*10mm

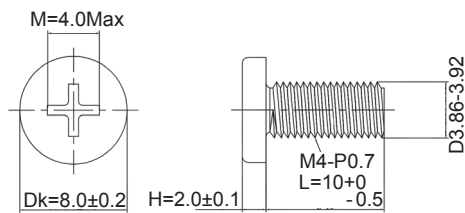

Specification for base screw: M6*13 mm (effective thread 5.5 mm)

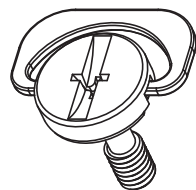

Adjusting the monitor

For optimal viewing it is recommended to look at the full face of the monitor, then adjust the monitor's angle to your own preference.

Hold the stand to steady the monitor, and grasp only the bezel to adjust the monitor's angle.

You are able to adjust the monitor as below:

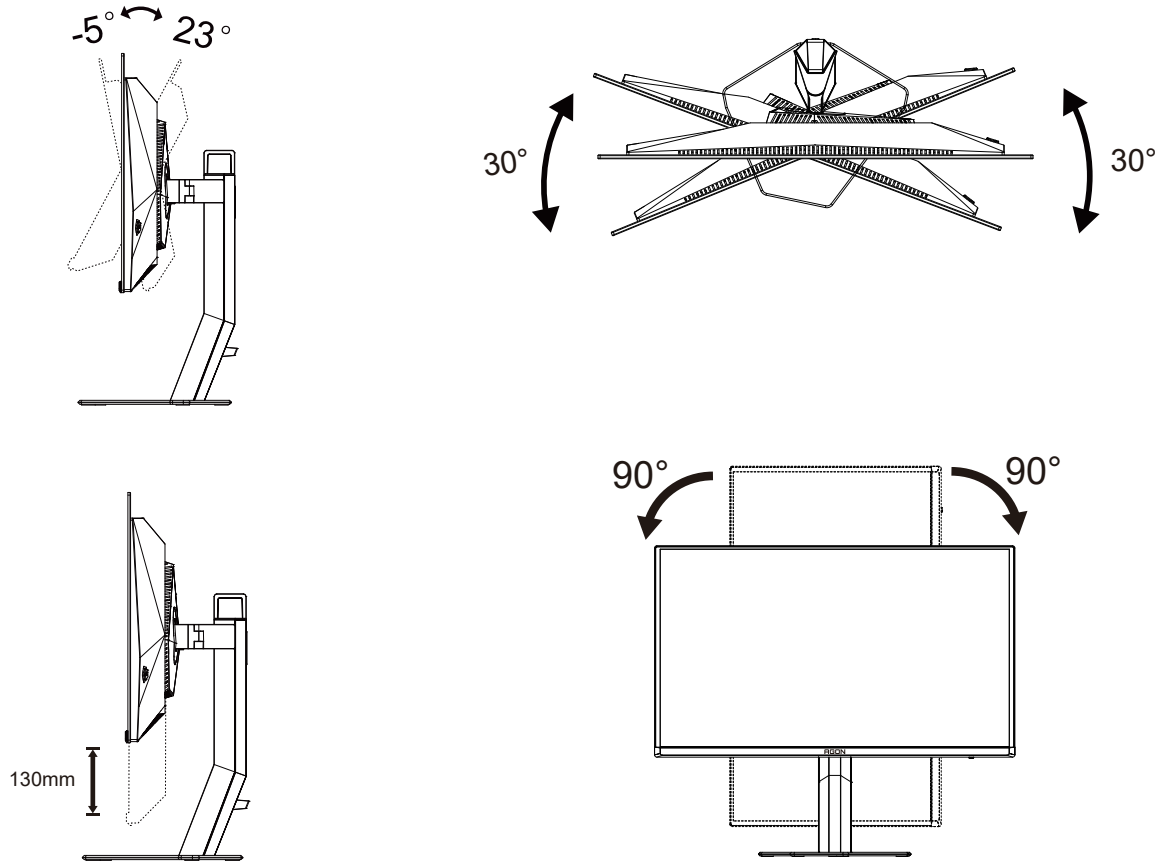

NOTE:

Do not touch the OLED screen when you change the angle. Touching the OLED screen may cause damage.

Warning:

1. To avoid potential screen damage, such as panel peeling, ensure that the monitor does not tilt downward by more than -5 degrees.
2. Do not press the screen while adjusting the angle of the monitor. Grasp only the bezel.

Connecting the Monitor

Cable Connections In Back of Monitor:

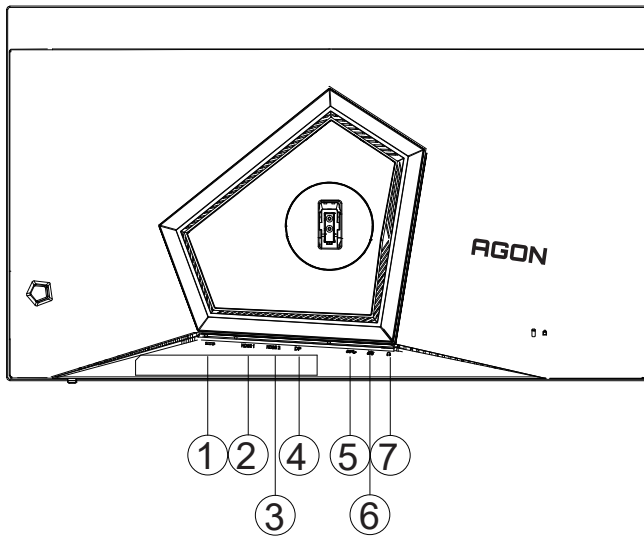

1. Power
2. HDMI1
3. HDMI2
4. DisplayPort
5. USB3.2 Gen1 upstream
6. USB3.2 Gen1 downstream + fast charging
USB3.2 Gen1 downstream x1
7. Earphone

Connect to PC

1. Connect the power cord to the back of the display firmly.
2. Turn off your computer and unplug its power cable.
3. Connect the display signal cable to the video connector on your computer.
4. Plug the power cord of your computer and your display into a nearby outlet.
5. Turn on your computer and display.

If your monitor displays an image, installation was successful and is complete. If your monitor does not display an image, please refer to the “Troubleshooting” section.

To protect equipment, always turn off the PC and OLED monitor before connecting.

Wall Mounting

Preparing to Install An Optional Wall Mounting Arm.

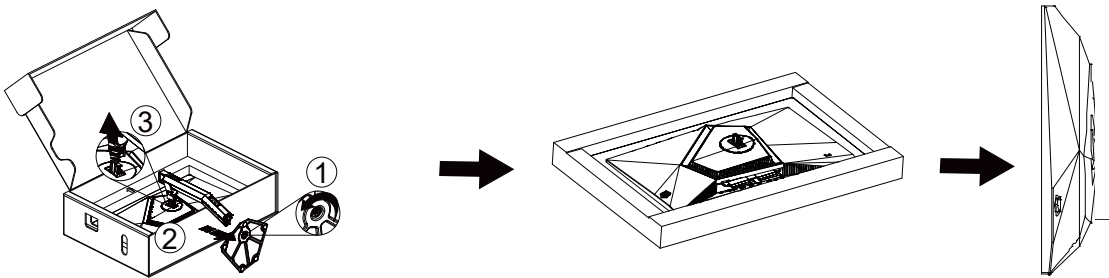

This monitor can be attached to a wall mounting arm you purchase separately. Disconnect power before this procedure. Follow these steps:

1. Remove the base.
2. Follow the manufacturer's instructions to assemble the wall mounting arm.
3. Place the wall mounting arm onto the back of the monitor. Line up the holes of the arm with the holes in the back of the monitor.
4. Reconnect the cables. Refer to the user's manual that came with the optional wall mounting arm for instructions on attaching it to the wall.



Noted: VESA mounting screw holes are not available for all models, please check with the dealer or official department of AOC.

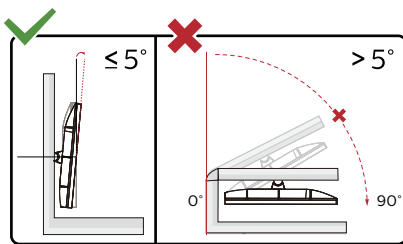

Display design may differ from those illustrated.

Warning :

1. To avoid potential screen damage, such as panel peeling, ensure that the monitor does not tilt downward by more than -5 degrees.
2. Do not press the screen while adjusting the angle of the monitor. Grasp only the bezel.

Adaptive-Sync function

1. Adaptive-Sync function is working with DisplayPort/HDMI
2. Compatible Graphics Card: Recommend list is as the below, also could be checked by visiting www.AMD.com

Graphics Cards

- Radeon™ RX Vega series
- Radeon™ RX 500 series
- Radeon™ RX 400 series
- Radeon™ R9/R7 300 series (R9 370/X, R7 370/X, R7 265 except)
- Radeon™ Pro Duo (2016)
- Radeon™ R9 Nano series
- Radeon™ R9 Fury series
- Radeon™ R9/R7 200 series (R9 270/X, R9 280/X except)

Processors

- AMD Ryzen™ 7 2700U
- AMD Ryzen™ 5 2500U
- AMD Ryzen™ 5 2400G
- AMD Ryzen™ 3 2300U
- AMD Ryzen™ 3 2200G
- AMD PRO A12-9800
- AMD PRO A12-9800E
- AMD PRO A10-9700
- AMD PRO A10-9700E
- AMD PRO A8-9600
- AMD PRO A6-9500
- AMD PRO A6-9500E
- AMD PRO A12-8870
- AMD PRO A12-8870E
- AMD PRO A10-8770
- AMD PRO A10-8770E
- AMD PRO A10-8750B
- AMD PRO A8-8650B
- AMD PRO A6-8570
- AMD PRO A6-8570E
- AMD PRO A4-8350B
- AMD A10-7890K
- AMD A10-7870K
- AMD A10-7850K
- AMD A10-7800
- AMD A10-7700K
- AMD A8-7670K
- AMD A8-7650K
- AMD A8-7600
- AMD A6-7400K

HDR

This monitor is compatible with HDR10 formatted input signals.

The display may automatically activate the HDR function if the player and content are compatible. Please contact the device manufacturer and the content provider for information on the compatibility of your device and content. If you have no need for the automatically activated HDR functions, please select “OFF” from the display settings menu.

Note:

1. 3840×2160@50Hz/60Hz is only available on devices such as UHD players or Xbox/PS.
2. Display Settings:
 - a. The display resolution is set to 2560x1440, and HDR is preset to ON. Under these conditions, the screen may slightly dim, indicating HDR has been activated.
 - b. After entering an application, the best HDR effect can be achieved when the resolution is changed to 2560x1440 (if available).

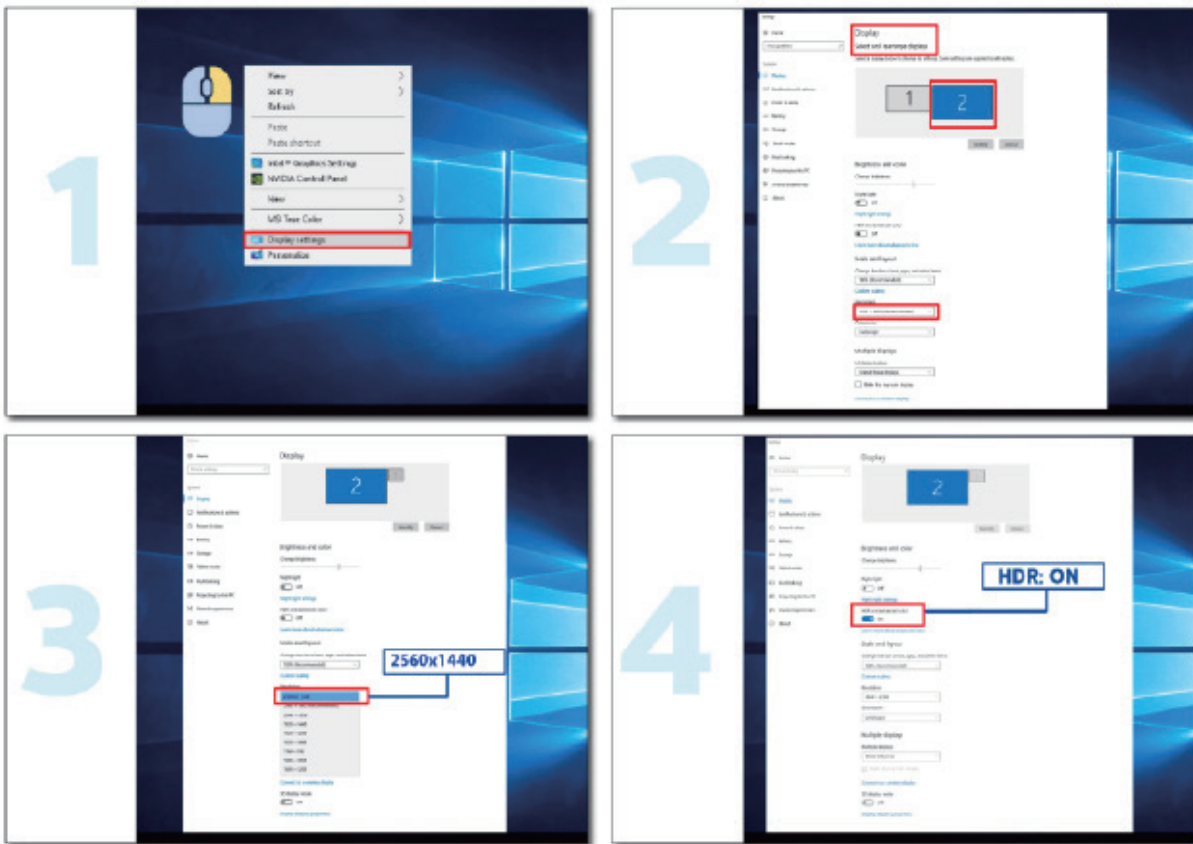

Adjusting

Hotkeys

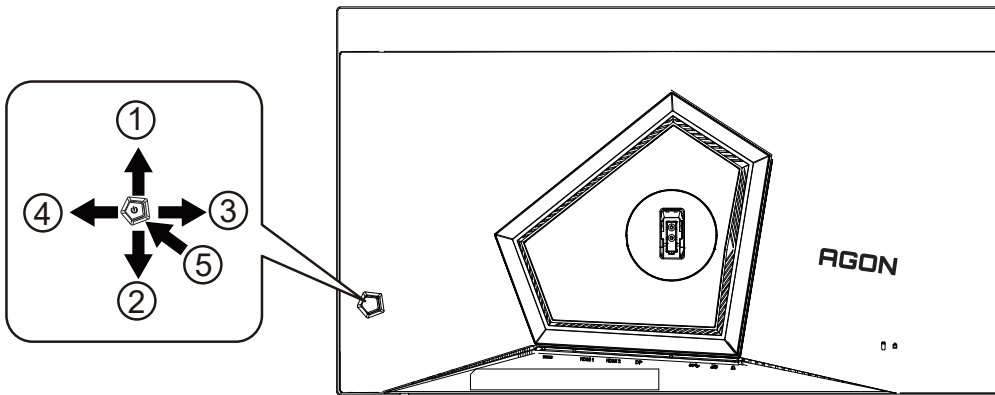

1	Source/Up
2	Dial Point/Down
3	User Key/Left
4	Light FX /Right
5	Power/ Menu/Enter

Power/Menu/Enter

Press the Power button to turn on the monitor.

When there is no OSD, Press to display the OSD or confirm the selection. Press about 2 seconds to turn off the monitor.

Dial Point/Down

When there is no OSD, press Dial Point button to show / hide Dial Point.

User Key/Left

Customize the functions of this shortcut key in the OSD menu: Game mode, sniper Mirror, frame counter. The factory preset is game mode.

Light FX/Right

When there is no OSD, press "Right" key to active Light FX function.

Source/Up

When the OSD is closed, press Source/Auto/Up button will be Source hot key function.

OSD Key Guide (Menu)



Enter : Use Enter key to enter the next OSD level

Move : Use Left / Up / Down key to move OSD selection

Exit : Use Right key to exit OSD



Enter : Use Enter key to enter the next OSD level

Move : Use Right / Up / Down key to move OSD selection

Exit : Use Left key to exit OSD



Enter : Use Enter key to enter the next OSD level

Move : Use Up / Down key to move OSD selection

Exit : Use Left key to exit OSD



Move : Use Left / Right / Up / Down Key to move OSD selection



Exit : Use Left key to exit OSD to previous OSD level

Enter : Use Right key to enter next OSD level

Select : Use Up / Down key to move OSD selection



Enter : Use Enter key to apply the OSD setting and back to previous OSD level

Select : Use Down key to adjust OSD setting



Select : Use Up / Down key to adjust OSD setting



Enter : Use Enter key to exit OSD to previous OSD level

Select : Use Left / Right key to adjust OSD setting

OSD Setting

Basic and simple instruction on the control keys.

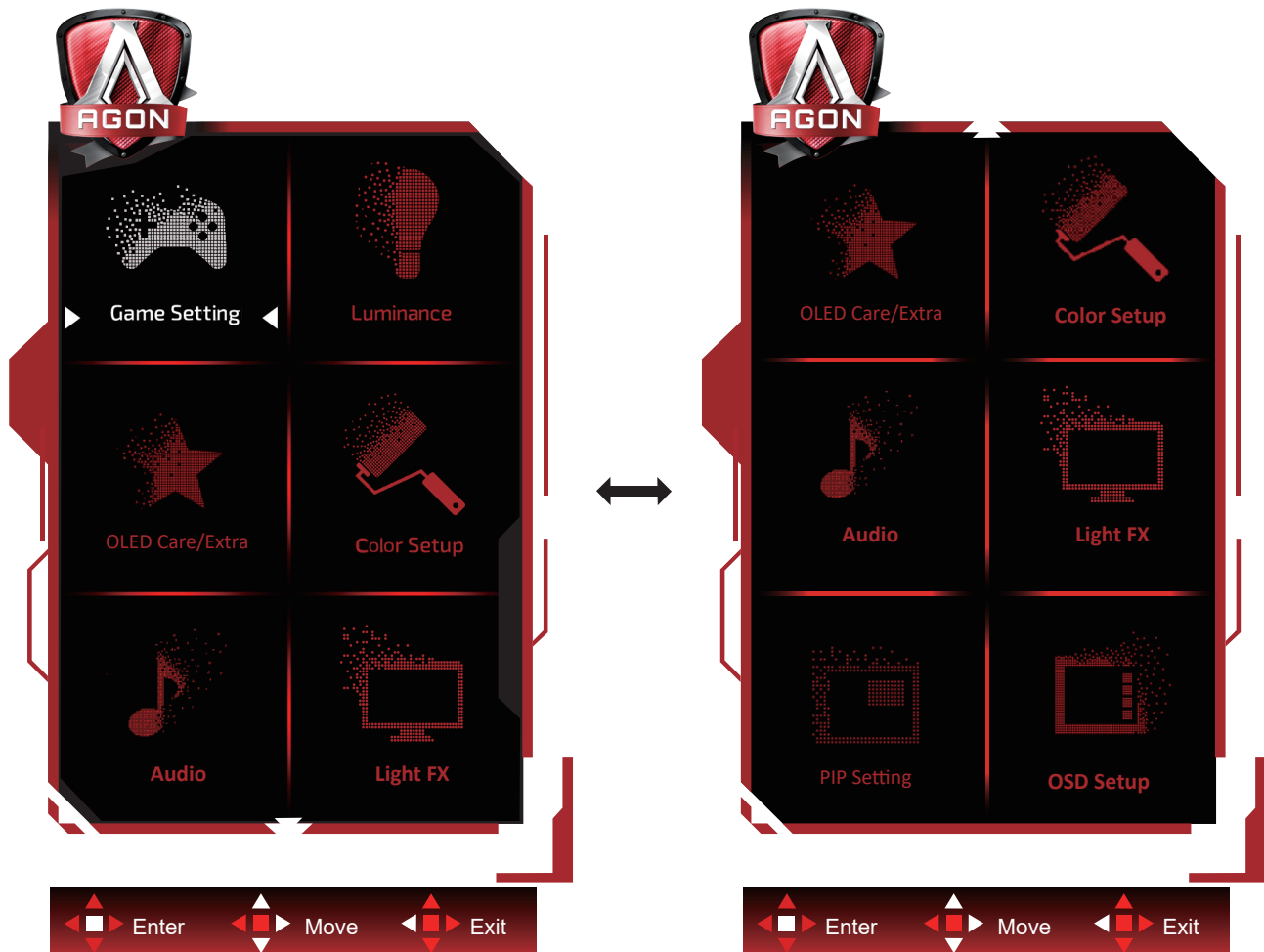

- 1). Press the MENU-button to activate the OSD window.
- 2). Follow Key Guide to move or select (adjust) OSD settings
- 3). OSD Lock/Unlock Function: To lock or unlock the OSD, press and hold the Down-button for 10s while OSD function is not active.

Notes:

If the product has only one signal input, the item of "Input Select" is disable to adjust.

Game Setting



	Game Mode	Off	No optimization by Game Mode.
		FPS	For playing FPS (First Person Shooters) games. Improves dark theme black level details.
		RTS	For playing RTS (Real Time Strategy). Improves the image quality.
		Racing	For playing Racing games, Provides fastest response time and high color saturation.
		Gamer 1	User's preference settings saved as Gamer 1.
		Gamer 2	User's preference settings saved as Gamer 2.
		Gamer 3	User's preference settings saved as Gamer 3.
	Shadow Control	0-20	Shadow Control Default is 0, then end-user can adjust from 0 to 20 to increase/decrease contrast for a clearer picture. 1. If picture is too dark to be saw the detail clearly, adjusting from 0 to 10 for clear a picture. 2. If picture is too white to be saw the detail clearly, adjusting from 10 to 20 for a clearer picture.
	Game Color	0-20	Game Color will provide 0-20 level for adjusting saturation to get better picture.
	Sniper Scope	Off /1.0 /1.5 /2.0	Zoom in locally to make it easier to target when shooting.
	Adaptive-Sync	On / Off	Disable or Enable Adaptive-Sync. Adaptive-Sync Run Reminder: When the Adaptive-Sync feature is enabled, there may be flashing in some game environments.

	Low Input lag	On / Off	Shutting down the frame buffer can reduce input delay. Note: Low input delay is disabled by default and unadjustable when the field frequency is less than 120 Hz; and it is enabled by default and unadjustable when the field frequency is equal to 120 Hz and in the AMD FreeSync Premium state.
	Frame Counter	Off / Right-Up / Right-Down / Left-Down / Left-Up	Display V frequency on the corner selected (Frame counter feature only works with AMD graphic card.)
	HDMI1	Console/DVD / PC	Select the type of connected device. Set HDMI1 as game machine/DVD when the game machine or DVD display is connected.
	HDMI2	Console/DVD / PC	Select the type of connected device. Set HDMI2 as game machine/DVD when the game machine or DVD display is connected.

Note:

“Luminance” controls “Game Mode,” “Shadow Control,” and “Game Color” can only be adjusted when “HDR Mode” and “HDR” are set to “OFF.”

When the Color Space under Color Settings is set to sRGB or DCI-P3, the Game Mode, Dark Field Control, and Game Tone items are not adjustable.

Luminance

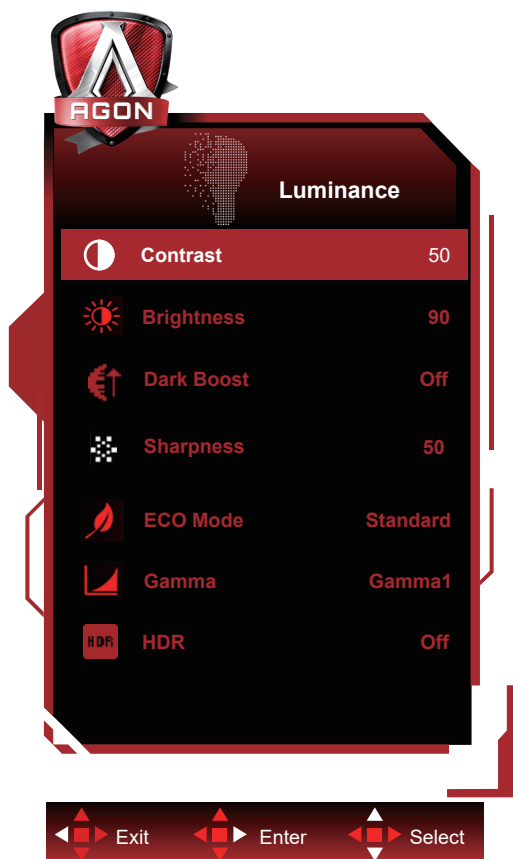

	Contrast	0-100	Contrast from Digital-register.
	Brightness	0-100	Backlight Adjustment
	Dark Boost	Off /Level 1 / Level 2 /Level 3	Enhance the screen details in the dark or bright area to adjust the brightness in the bright area and ensure that it is not oversaturated.
	Sharpness	0-100	Sharpness Adjustment.
	Eco mode	Standard	Standard Mode
		Text	Text Mode
		Internet	Internet Mode
		Game	Game Mode
		Movie	Movie Mode
		Sports	Sports Mode
		Reading	Reading Mode
	Gamma	Gamma1	Adjust to Gamma 1
		Gamma2	Adjust to Gamma 2
		Gamma3	Adjust to Gamma 3
	HDR	Off	Set the HDR profile according to your usage requirements. Note: When HDR is detected, the HDR option is displayed for adjustment.
		DisplayHDR	
		HDR Peak	
		HDR Picture	
		HDR Movie	
	HDR Mode	HDR Game	Optimized for the color and contrast of the picture, which will simulate showing the HDR effect. Note: When HDR is not detected, the HDR Mode option is displayed for adjustment.
		Off	
		HDR Picture	
		HDR Movie	
		HDR Game	

Note:

“Luminance” controls “Contrast,” “Eco Mode,” and “Gamma” can only be adjusted when “HDR Mode” is set to “OFF.”

No “Luminance” controls are adjustable when “HDR” is active.

When the Color Space under Color Settings is set to sRGB or DCI-P3, the Contrast, Brightness Scenario Mode, Gamma, and HDR/HDR Mode items are not adjustable.

OLED Care/Extra



	Pixel Orbiting	Off / Weak / Medium / Strong	<p>Orbit will slightly shift the displayed image at the pixel level, once a second to prevent image retention.</p> <p>This function is “On (Weak)” by default, “Weak” moves the least, “Strong” moves the most, “Off” disables the movement and increases the chance of image retention. This can be set in the OSD menu.</p>
	Auto Warning	On/ Off	<p>Enable/Disable the "Pixel Refresh" Auto Warning feature.</p> <p>The monitor will automatically display an “Auto Warning” every 4 hours of cumulative usage to remind the user to run the "Pixel Refresh" process.</p> <p>Select "Off" to stop the Auto Warning for "Pixel Refresh." However, if the recommended time for running the "Pixel Refresh" is not followed, it may increase the risk of image retention on the screen. Please proceed with caution.</p>
	Pixel Refresh	On/ Off	<p>This function will help eliminate image retention.</p> <p>After startup, select “Yes” from the menu prompt. The display will shutdown the screen and run the maintenance cycle. The power indicator will flash white (1 second on/1 second off) while the cycle runs, about 10 minutes. At the end of the cycle the power indicator will turn off and the display will be in standby state.</p>
	Screen Saver	Off / Slow / Fast	<p>When a static image is detected for a certain period of time, the screen saver function will dim the screen to protect the panel from sticking. When a moving image is detected, the monitor will recover luminance to previous working status. Default setting is Slow and may change as Fast to activate Screen Saver sooner. Would highly recommend that you always turn on Screen Saver as Slow or Fast to protect the screen. It is also recommended that you also set your device to use a screen saver.</p>

Logos Protection	Off / 1 / 2 / 3 / 4	When there are multiple static logos detected on the screen, it's suggested to turn on logos Protection; which will dim the screen to protect the panel from image sticking where logos are detected.
Boundary Dimmer	Off / 1 / 2 / 3 / 4	For special aspect ratios that have a black area in the frame of the screen or a split-screen, the boundary dimmer feature can automatically detect and dim the brightness of specific areas with a large difference in brightness levels.
Taskbar Dimmer	Off / 1 / 2 / 3 / 4	The Taskbar Dimmer technology will dim the brightness of the taskbar area on the screen. No brightness changes will be noticeable in the areas other than in the taskbar.
ThermalProtection	Off / On	When the temperature of the monitor is over 60 degrees Celsius, the Thermal Protection feature will automatically dim the brightness of the screen in order to ensure heat dissipation properly. It is recommended that you turn on the feature for the monitor.
Input Select	Auto/ HDMI1/ HDMI2/ DP	Select Input Signal Source
Off Timer	0-24	Select DC off time
Image Ratio	Wide /Aspect / 4:3 / 1:1 / 17"(4:3) / 19"(4:3) / 19"(5:4) / 19"W(16:10) / 21.5"W(16:9) / 22"W(16:10) / 23"W(16:9) / 23.6"W(16:9) / 24"W(16:9)	Select image ratio for display.
DDC/CI	Yes or No	Turn On/Off DDC/CI Support
Reset	Yes or No	Reset the menu to default
Time after Pixel Refresh (Time since last elimination of image retention)		Refers to the number of hours of screen operation since the last time Pixel Refresh was run. A prompt to run Pixel Refresh will be displayed automatically every four hours.
Pixel Refresh Counts (Number of times of eliminating image retention)		Records the number of times Pixel Refresh has been run.

Color Setup

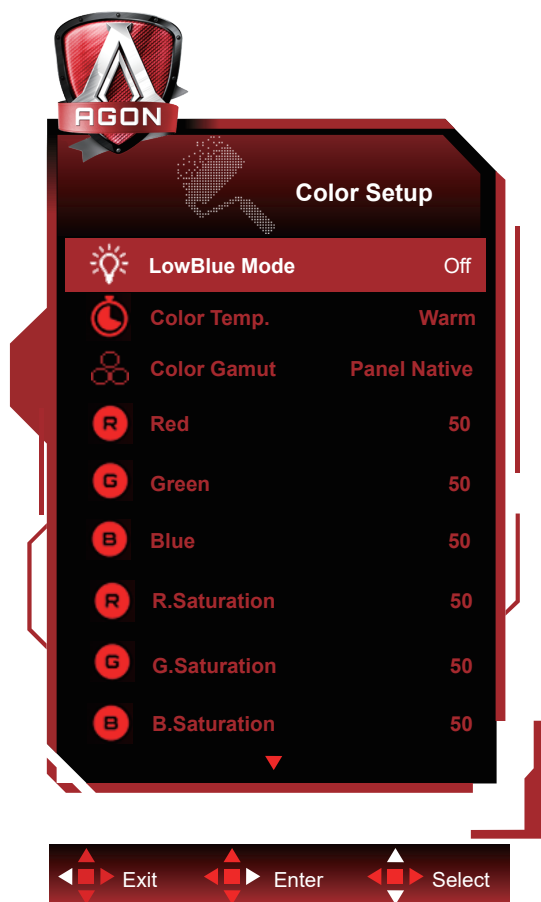

	LowBlue Mode	Off / Multimedia / Internet / Office / Reading	Decrease blue light wave by controlling color temperature.
	Color Temp.	Warm	Recall Warm Color Temperature from EEPROM.
		Normal	Recall Normal Color Temperature from EEPROM.
		Cool	Recall Cool Color Temperature from EEPROM.
		User	Restore user color temperature from EEPROM.
	Color Gamut	Panel Native	Standard color space panel.
		sRGB	Recall sRGB Color Temperature from EEPROM.
		DCI-P3	DCI-P3 color space.
	Red	0-100	Red gain from Digital-register.
	Green	0-100	Green gain from Digital-register.
	Blue	0-100	Blue gain from Digital-register.
	R.Saturation	0-100	R.Saturation gain from Digital-register.
	G.Saturation	0-100	G.Saturation gain from Digital-register.
	B.Saturation	0-100	B.Saturation gain from Digital-register.
	C.Saturation	0-100	C.Saturation gain from Digital-register.
	M.Saturation	0-100	M.Saturation gain from Digital-register.
	Y.Saturation	0-100	Y.Saturation gain from Digital-register.
	R.Hue	0-100	R.Hue gain from Digital-register.
	G.Hue	0-100	G.Hue gain from Digital-register.
	B.Hue	0-100	B.Hue gain from Digital-register.

	C.Hue	0-100	C.Hue gain from Digital-register.
	M.Hue	0-100	M.Hue gain from Digital-register.
	Y.Hue	0-100	Y.Hue gain from Digital-register.

Note:

“Luminance” controls under “Color Setup” can only be adjusted when “HDR Mode” or “HDR” is set to “OFF.”
When Color Space is set to sRGB or DCI-P3, all other items under Color Settings cannot be adjusted.

Audio

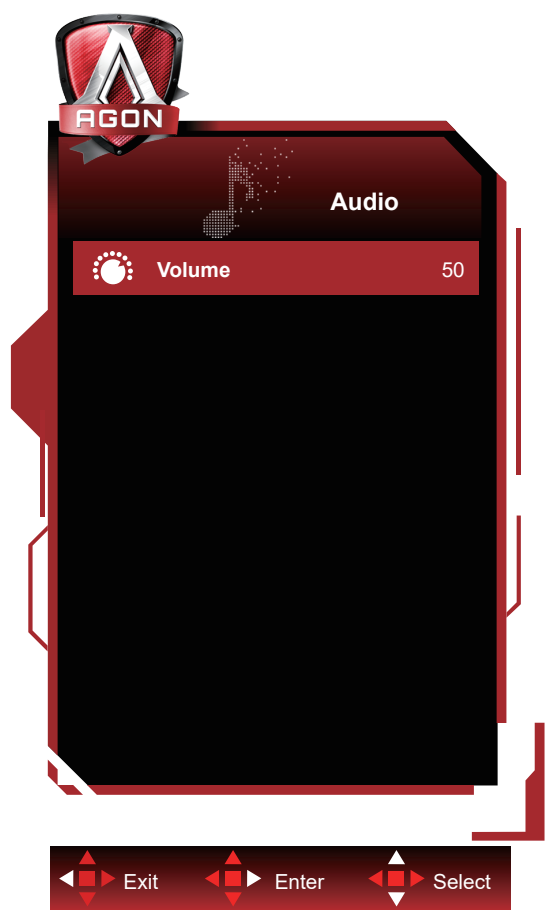

	Volume	0-100	Adjust volume setting
---	--------	-------	-----------------------

Light FX

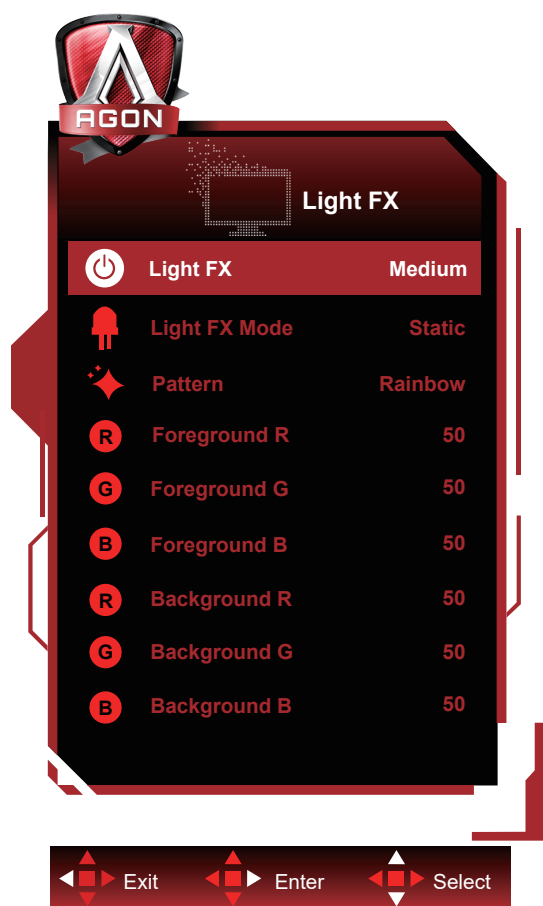

	Light FX	Off / Low / Medium / Strong	Select the intensity of Light FX.
	Light FX Mode	Audio1 / Audio2 / Static / Dark Point Sweep / Gradient Shift / Spread Fill / Drip Fill / Spreading Drip Fill / Breathing / Light Point Sweep / Zoom / Rainbow / Wave / Flashing / Demo	Select Light FX Mode
	Pattern	Red / Green / Blue / Rainbow / User Define	Select Light FX Pattern
	Foreground R	0-100	User can adjust Light FX foreground color, when Pattern setting to user define
	Foreground G		
	Foreground B		
	Background R	0-100	User can adjust Light FX background color, when Pattern setting to user define
	Background G		
	Background B		

PIP Setting

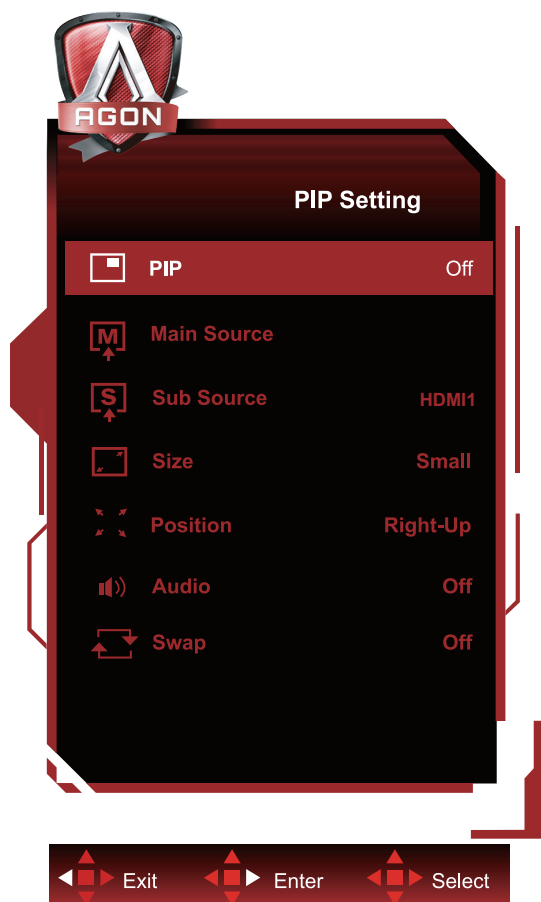

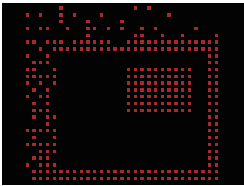
	PIP Setting	Off / PIP / PBP	Disable or Enable PIP or PBP.
	Main Source		Select main screen source.
	Sub Source		Select sub screen source.
	Size	Small / Middle / Large	Select screen size.
	Position	Right-up	Set the screen location.
		Right-down	
		Left-up	
		Left-down	
	Audio	On: PIP Audio	Disable or Enable Audio Setup.
		Off: Main Audio	
	Swap	On: Swap	Swap the screen source.
		Off: non action	

Note:

- 1) No "PIP Setting" under "Brightness" controls are adjustable when "HDR" is active.
- 2) When PIP/PBP is enabled, some color-related adjustments in the OSD menu are valid only for the main screen, while the sub-screen is not supported. Hence, the main screen and the sub-screen may have different colors.
- 3) Set the input signal resolution to 1280X1440@60Hz at PBP to achieve the desired display effect.
- 4) When PBP/PIP is enabled, the compatibility of the main screen/sub-screen input source is shown in the following table:

PBP/PIP		Main source		
		HDMI1	HDMI2	DP
Sub source	HDMI1	V	V	V
	HDMI2	V	V	V
	DP	V	V	V

OSD Setup

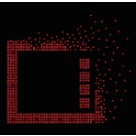

	Language		Select the OSD language
	Timeout	5-120	Adjust the OSD Timeout
	H. Position	0-100	Adjust the horizontal position of OSD
	V. Position	0-100	Adjust the vertical position of OSD
	Transparency	0-100	Adjust the transparency of OSD
	Break Reminder	On /Off	Enable a reminder for the user to take a break every hour of continuous activity, to prevent repetitive stress injury.
	User Key	Game Mode / Sniper Scope / Frame Counter	

LED Indicator

Status	LED Color
Full Power Mode	White
Active-off Mode	Orange
Pixel Refresh under process	Flashing White (1 second on/1 second off)
OLED panel malfunction	Flashing Orange (1 second on/1 second off)
Shutdown mode	The indicator is not lit.

Troubleshooting

Problem	Possible solutions
The power indicator is not lit.	<ul style="list-style-type: none"> • Check if the power is turned on. • Check if the power cord is connected.
The power indicator is lit, but there is no image displayed.	<ul style="list-style-type: none"> • Check if the computer is powered on. • Use the Caps Lock key indicator to determine if the computer is responsive. • Check if the graphics card is properly seated and powered. • Check that the video cable is correctly connected between computer and display. • Check that the video cable plugs do not have bent pins.
There is no image, but the power indicator flashes orange.	<ul style="list-style-type: none"> • The OLED display is malfunctioning. Please contact AOC support for service.
Failure to Plug-and-Play.	<ul style="list-style-type: none"> • Check if the computer supports Plug-and-Play. • Check if the video adapter supports Plug-and-Play.
Dim image.	<ul style="list-style-type: none"> • Adjust luminance and contrast ratio.
The image is bouncing or rippled.	<ul style="list-style-type: none"> • There may be electrical interference occurring from nearby appliances or devices. Move the computer and monitor away from the interfering devices to resolve the problem.
The screen displays “the signal wire is not available” or “no signal.”	<ul style="list-style-type: none"> • Unplug and plug in the video cable. • Inspect the video cable pins for damage.
The screen displays “invalid input”.	<ul style="list-style-type: none"> • Reset the computer output to a display mode compatible with the display.
Image retention.	<ul style="list-style-type: none"> • Use the Pixel Refresh function to eliminate image retention from the screen. Refer to the “Screen Maintenance” section.
Regulation & Service	Please refer to Regulation & Service Information which is in the CD manual or www.aoc.com (to find the model you purchase in your country and to find Regulation & Service Information in Support page.

Specification

General Specification

Panel	Model Name	AG276QKD2	
	Driving System	OLED	
	Viewable Image Size	67.3 cm Diagonal	
	Pixel Pitch	0.2292mm(H) x 0.2292mm(V)	
	Display Color	1.07B Colors	
Others	Horizontal Scan Range	30k~510kHz	
	Horizontal scan Size(Maximum)	590.42 mm	
	Vertical Scan Range	48~500Hz	
	Vertical Scan Size(Maximum)	333.72 mm	
	Optimal Preset Resolution	2560 x 1440@60Hz	
	Max Resolution	2560 x 1440@500Hz	
	Plug & Play	VESA DDC2B/CI	
	Connector	HDMIx2/DisplayPort/USBx2/USB upstream/Earphone	
	Power Source	19.5V  6.93A	
	Power Consumption	Typical(Default Brightness And Contrast)	83 W
		Max. (Brightness = 100, Contrast =100)	≤147 W
		Standby Mode	≤ 0.5 W
Environmental	Temperature	Operating	0°C~ 40°C
		Non-Operating	-25°C~ 55°C
		Perform JB Function to Recommend Temperature	0°C~ 40°C
	Humidity	Operating	10%~85% (Non-Condensing)
		Non-Operating	5%~93% (Non-Condensing)
	Altitude	Operating	0m~5000m (0ft~16404ft)
		Non-Operating	0m~12192m (0ft~40000ft)

Note:

This product supports a maximum display color count of 1.07 billion. The setting conditions are as follows: (Due to the strategies of various graphics cards, some options may be hidden. The actual support of the graphics card is subject to change.)

The graphics card needs to have DSC function:

<div> <div>Signal Version</div> <div>Color Format</div> <div>State</div> <div>Color Bit</div> </div>	HDMI2.1		DisplayPort2.1	
	YCbCr422 YCbCr420	YCbCr444 RGB	YCbCr422 YCbCr420	YCbCr444 RGB
2560x1440 500Hz 10bits	V(DSC)	V(DSC)	V(DSC)	V(DSC)
2560x1440 500Hz 8bits	V(DSC)	V(DSC)	V(DSC)	V(DSC)
2560x1440 360Hz 10bits	OK	V(DSC)	OK	V(DSC)
2560x1440 240Hz 10bits	OK	OK	OK	OK
2560x1440 120Hz 10bits	OK	OK	OK	OK
2560x1440 120Hz 8bits	OK	OK	OK	OK
Low resolution 10bits	OK	OK	OK	OK
Low resolution 8bits	OK	OK	OK	OK

If the graphics card DP2.1 is 20G, then DP does not require DSC. If the graphics card is 13.5G, then DP needs DSC to light up normally.

Preset Display Modes

STANDARD	RESOLUTION (±1Hz)	HORIZONTAL FREQUENCY(kHz)	VERTICAL FREQUENCY(Hz)
VGA	640×480@60Hz	31.469	59.940
	640×480@72Hz	37.861	72.809
	640×480@75Hz	37.500	75.000
	640×480@100Hz	51.080	99.769
	640×480@120Hz	60.938	119.720
SVGA	800×600@56Hz	35.156	56.250
	800×600@60Hz	37.879	60.317
	800×600@72Hz	48.077	72.188
	800×600@75Hz	46.875	75.000
	800×600@100Hz	62.760	99.778
	800×600@120Hz	76.302	119.972
XGA	1024×768@60Hz	48.363	60.004
	1024×768@70Hz	56.476	70.069
	1024×768@75Hz	60.023	75.029
SXGA	1280×1024@60Hz	63.981	60.020
	1280×1024@75Hz	79.976	75.025
FHD	1920×1080@60Hz	67.500	60.000
	1920×1080@120Hz	137.260	119.982
QHD	2560×1440@60Hz	96.180	60.000
	2560×1440@120Hz	192.360	120.000
	2560×1440@165Hz	242.543	164.995
	2560×1440@240Hz	384.722	240.001
	2560×1440@360Hz	529.201	360.001
	2560×1440@500Hz	834	500
PBP	1280×1440@60Hz	89.450	59.913
	1280×1440@75Hz	111.972	74.998
	1280×1440@120Hz	179.157	119.998
	1280×1440@144Hz	214.994	144.002
	1280×1440@240Hz	358.320	240.000
	1280×1440@360Hz	537.485	360.004
IBM MODES			
DOS	720×400@70Hz	31.469	70.087
MAC MODES			
VGA	640×480@67Hz	35.000	66.667
SVGA	832×624@75Hz	49.725	74.551

Note: According to the VESA standard, different operating systems and graphics cards may have certain errors (+/-1Hz) on resolution. Actual please refer to the actual product.

Pin Assignments



19-Pin Color Display Signal Cable

Pin No.	Signal Name	Pin No.	Signal Name	Pin No.	Signal Name
1.	TMDS Data 2+	9.	TMDS Data 0-	17.	DDC/CEC Ground
2.	TMDS Data 2 Shield	10.	TMDS Clock +	18.	+5V Power
3.	TMDS Data 2-	11.	TMDS Clock Shield	19.	Hot Plug Detect
4.	TMDS Data 1+	12.	TMDS Clock-		
5.	TMDS Data 1Shield	13.	CEC		
6.	TMDS Data 1-	14.	Reserved (N.C. on device)		
7.	TMDS Data 0+	15.	SCL		
8.	TMDS Data 0 Shield	16.	SDA		

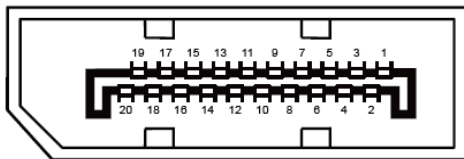

20-Pin Color Display Signal Cable

Pin No.	Signal Name	Pin No.	Signal Name
1	ML_Lane 3 (n)	11	GND
2	GND	12	ML_Lane 0 (p)
3	ML_Lane 3 (p)	13	CONFIG1
4	ML_Lane 2 (n)	14	CONFIG2
5	GND	15	AUX_CH(p)
6	ML_Lane 2 (p)	16	GND
7	ML_Lane 1 (n)	17	AUX_CH(n)
8	GND	18	Hot Plug Detect
9	ML_Lane 1 (p)	19	Return DP_PWR
10	ML_Lane 0 (n)	20	DP_PWR

Plug and Play

Plug & Play DDC2B Feature

This monitor is equipped with VESA DDC2B capabilities according to the VESA DDC STANDARD. It allows the monitor to inform the host system of its identity and, depending on the level of DDC used, communicate additional information about its display capabilities.

The DDC2B is a bi-directional data channel based on the I2C protocol. The host can request EDID information over the DDC2B channel.



For DTS patents, see <http://patents.dts.com>. Manufactured under license from DTS Licensing Limited. DTS, the Symbol, & DTS and the Symbol together are registered trademarks, and DTS Sound is a trademark of DTS, Inc. © DTS, Inc. All Rights Reserved.